

Td FITTINGS

EN 10242 Design Symbol "A"

Index Values
Index - Werte
Valeurs Indices
Valori Indice

2 0 0 9

- Malleable iron fittings • Raccordi en fonte malléable
- Tempergussfittings • Raccordi di ghisa malleabile



ERKU

Foreign Trade & Marketing Inc.



DIN-DVGW-Baumusterprüfzertifikat DIN-DVGW type examination certificate

NV-7641BQ0323

Registriernummer
registration number

Anwendungsbereich <i>field of application</i>	Produkte der Gas- und Wasserversorgung <i>products of gas and water supply</i>
Zertifikatinhaber <i>owner of certificate</i>	Trakya Döküm Sanayi ve Ticaret A.S. Büyükdere Cad. Soyak Binası No. 38, TR-80290 Mecidiyeköy/Istanbul
Vertreiber <i>distributor</i>	Trakya Döküm Sanayi ve Ticaret A.S. Büyükdere Cad. Soyak Binası No. 38, TR-80290 Mecidiyeköy/Istanbul
Produktart <i>product category</i>	metal pipe unions and joints : malleable cast iron fitting (7641)
Produktbezeichnung <i>product description</i>	malleable cast iron fitting, design symbol "A"
Modell <i>model</i>	Td
Prüfberichte <i>test reports</i>	type testing: B 05/08/0772 from 26.08.2005 (DBI)
Prüfgrundlagen <i>basis of type examination</i>	DIN EN 10242 (01.03.1995) DIN EN 10242/A1 (01.06.1999) DIN EN 10242/A2 (01.06.2003)

Ablaufdatum / AZ 26.08.2010 / 05-0174-WNE
date of expiry / file no.

20.09.2005 K8 A-1/2
Datum, Bearbeiter, Blatt, Leiter der Zertifizierungsstelle
date, issued by, sheet, head of certification body

DVGW-Zertifizierungsstelle - von der Deutschen Akkreditierungsstelle Technik (DATech) e.V. akkreditiert für die Konformitätsbewertung von Produkten der Gas- und Wasserversorgung

DVGW Certification Body - accredited by Deutsche Akkreditierungsstelle Technik (DATech) e.V. for conformity assessment of products of gas and water supply

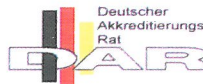

DAT-ZE-009/96-11

DVGW Deutsche Vereinigung
des Gas- und Wasserfaches e.V.
Technisch-wissenschaftlicher
Verein
Zertifizierungsstelle
Josef-Wirmer-Straße 1-3
53123 Bonn
Telefon: +49 (228) 91 88 807
Telefax: +49 (228) 91 88 993

Introduction

Trakya Dokum, with its modern production facilities and experienced personnel, is the leading malleable cast iron fitting manufacturer in Turkey, producing fittings compliant with EN 10242 Design Symbol "A". High quality malleable cast iron fittings have been manufactured by Trakya Dokum since 1982 using modern machinery and equipment.

The fittings production line is equipped with a Disamatic 2013 Mk 4, Junker Presspour and main frequency melting furnaces. Special care has been taken to select modern sophisticated technology from Western Europe and the USA in all sections of sand preparation, core-making, fettling, heat treatment, galvanising, thread-cutting, laboratories and pattern-making, enabling the company to produce superior cast iron fittings for sales all around the world.

Product standards

Td malleable cast iron fittings are in accordance with the current ISO 49 and EN 10242 standards and are designated with the design symbol A.

Threads

Basic fitting threads are jointing threads, where ISO 7-1 applies. Internal threads are parallel (Rp) and external threads are 1:16 taper (R). Threads, which are fastening threads according to ISO 228/1, are marked with G on the symbol picture.

Surface finish

Our Td malleable cast iron fittings are provided in black or hot dip galvanized finish, covered with a preservative for temporary prevention of rust film. Td fittings can be delivered in black or galvanized finish as requested by the purchaser. As prescribed by the standard EN 10242, the mass of zinc coating shall not be less than 500gr/m² which corresponds to a medium layer thickness of 70 µm.

"Fittings marked with (*) are exceptions. They are made of steel and if a galvanized finish is required for these fittings, it can only be possible through electroplating for technical reasons"

Dimensions

All dimensions, z-dimensions and other technical data can be found in the catalogue.

Size designation

The naming of fitting types starts with the most basic type definition and some basic features follow that. As far as the sequence of connection sizes are concerned, the following simple set of rules applies.

- For equal fittings, individual connection size is sufficient
- For reducing fittings with 2 connections of different sizes, the connection size of the larger connection is given first, followed by the smaller connection.
- For fittings with 3 or more connections (illustrations 1 and 4), the throughput size is given first, and in the case of equal connections on the run, it is followed by the size of the branch.

- For 3 different connections or sections reduced in the run, the sequence for the designation of connections is according to illustrations 2 and 3.

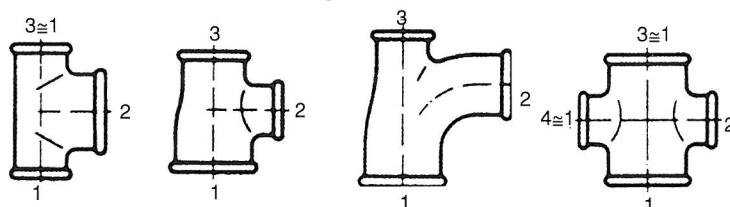

Weight information

The weight values given in this catalogue are "nominal values". Differences in weight can occur in cast iron products for technical reasons.

Flat seat unions

Flat seat unions are supplied without gaskets. They can be dismantled (radially) and re-assembled.

Unions with metallic sealing

Seats of metallic sealing unions must be cleaned and greased before use. For potable water applications, they should be cleaned and lubricated with a potable water approved thread sealant (e.g. thread sealing paste complying to DIN 30660.)

Quality testing/ leak test

Applying the standard EN 10242, each individual Td fitting is subjected to a pressure test with a minimum hydrostatic pressure of 20 bar, which is equivalent to a pneumatic pressure of minimum 5 bar.

Key

BLK	Black
GAL	Galvanized
*	Types of fittings that are made of steel (galvanized finish = electro-plated) and unsuitable for potable water installations.
Code	Td part number
ISO	Designates ISO 49
Bag	Quantity per standard pack
Carton	Quantity per carton
Gr	~ Piece weight in grams
G	Fastening thread not sealing in the joint as defined by ISO 228.

Ordering information

Td malleable cast iron fittings (Design Symbol A) should be ordered giving the following details :

1. Td code
2. Quantity

If it is not convenient to use the coding system, Td malleable cast iron fittings can also be ordered using individual feature definitions, as shown below:

According to standard:

Elbow EN 10242 – A1 – 2 Zn – A

Elbow	type of fitting
EN 10242 (ISO 49)	standard
A1	symbol
2	fitting size
Zn	surface finish hot dip zinc coated
A	Design Symbol

Product range
Sortimentübersicht
Gamme
Gamma

1	1a	2	2a	3	40
					
41	85	87	90	90R	92
					
92R	95	96	97	98	120
					
121	130	130R	131	180	180R
					
240	241	245	246	270	271
					
280	290	291	300	310	330
					
331	340	341	370	371	372
					
374	529a				
					

Correlation Trakya Döküm catalogue number - ISO/EN symbol
 Gegenüberstellung Trakya Döküm Kat.-Nr.- ISO/EN-Kurzzeichen
 Tableaux de correspondance entre numéro de cat. Trakya Döküm et symboles ISO/EN
 Confronto numero di catalogo Trakya Döküm - sigla ISO/EN

Trakya Döküm	ISO/EN	Trakya Döküm	ISO/EN
1	G4	245	N8 red
1a	D4	246	M4 red
2	G1	270	M2
2a	D1	271	M2 R-L
3	G8	280	N8
40	G4/45°	290	T9
41	G1/45°	291	T8
85		300	T1
87		310	P4
90	A1	330	U1
90R	A1	331	U2
92	A4	340	U11
92R	A4	341	U12
95	UA1	370	
96	UA11	371	
97	UA2	372	
98	UA12	374	
120	A1/45°	529a	M4
121	A4/45°		
130	B1		
130R	B1		
131	E1		
180	C1		
180R	C1		
240	M2 red		
241	N4		

ISO/EN	Trakya Döküm	ISO/EN	Trakya Döküm
A1	90	N8	280
A1	90R	N8 red	245
A1/45°	120	P4	310
A4	92	T1	300
A4	92R	T8	291
A4/45°	121	T9	290
B1	130	U1	330
B1	130R	U2	331
C1	180	U11	340
C1	180R	U12	341
D4	1a	UA1	95
E1	131	UA2	97
G1	2	UA11	96
G1/45°	41	UA12	98
G4	1		
G4/45°	40		
G8	3		
M2	270		
M2 R-L	271		
M2 red	240		
M4	529a		
M4 red	246		
N4	241		

Starting with Trakya Döküm Cat.Nr.
 Suchbegriff Trakya Döküm Kat.-Nr.
 Disposition selon No Cat. Trakya Döküm
 Disosizione secondo No. Cat. Trakya Döküm

Starting with ISO/EN symbols
 Suchbegriff ISO/EN-Kurzzeichen
 Disposition selon symbole ISO/EN
 Disposizione secondo sigla ISO/EN

Correlation of the inch and mm sizes
 Tabella Zoll/mm-Abmessungen
 Comparaison des grandeurs de raccordement en pouce et en mm
 Confronto dei valori in pollici et in mm

Fitting size Anschlussgrösse Grandeur de raccordement Dimensione di giunzione	1/8	1/4	3/8	1/2	3/4	1	1 1/4	1 1/2	2	2 1/2	3	4
Nominal size DN Nennweite DN Diamètre nominal DN Diametri nominali DN	6	8	10	15	20	25	32	40	50	65	80	100

1

ISO/EN (G4)

Long sweep bend

Langer bogen

Courbe à grand rayon

Curva lunga

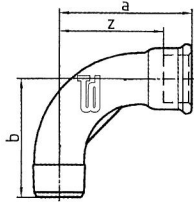

	Size	Code	Index	Bag	Carton	Gr
BLK	1/2	FS00010002	3,80	10	180	115
GAL	1/2	FG00010002	4,80	10	180	120
BLK	3/4	FS00010003	6,65	10	100	200
GAL	3/4	FG00010003	8,40	10	100	210
BLK	1	FS00010004	9,00		60	320
GAL	1	FG00010004	11,40		60	340
BLK	1 1/4	FS00010005	15,95		30	525
GAL	1 1/4	FG00010005	19,80		30	550
BLK	1 1/2	FS00010006	20,55		25	685
GAL	1 1/2	FG00010006	26,15		25	720
BLK	2	FS00010007	34,05		12	1400
GAL	2	FG00010007	42,25		12	1440

	Dimension	Code	a	b	z	z1
BLK	1/2	FS00010002	55	48	42	
GAL	1/2	FG00010002				
BLK	3/4	FS00010003	69	60	54	
GAL	3/4	FG00010003				
BLK	1	FS00010004	85	75	68	
GAL	1	FG00010004				
BLK	1 1/4	FS00010005	105	95	86	
GAL	1 1/4	FG00010005				
BLK	1 1/2	FS00010006	116	105	97	
GAL	1 1/2	FG00010006				
BLK	2	FS00010007	140	130	116	
GAL	2	FG00010007				

1a

ISO/EN (D4)

Short bend

Kurzer bogen

Courbe courte

Curva corta

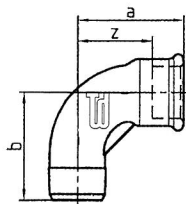

	Size	Code	Index	Bag	Carton	Gr
BLK	1/2	FS001A0002	3,45	10	180	120
GAL	1/2	FG001A0002	4,40	10	180	125
BLK	3/4	FS001A0003	5,45	10	100	200
GAL	3/4	FG001A0003	6,75	10	100	205
BLK	1	FS001A0004	7,25		60	330
GAL	1	FG001A0004	9,05		60	350
BLK	1 1/4	FS001A0005	10,65		30	530
GAL	1 1/4	FG001A0005	13,75		30	550
BLK	1 1/2	FS001A0006	15,60		25	705
GAL	1 1/2	FG001A0006	19,80		25	730
BLK	2	FS001A0007	28,00		12	1285
GAL	2	FG001A0007	34,65		12	1335

	Dimension	Code	a	b	z	z1
BLK	1/2	FS001A0002	45	45	32	
GAL	1/2	FG001A0002				
BLK	3/4	FS001A0003	50	50	35	
GAL	3/4	FG001A0003				
BLK	1	FS001A0004	63	63	46	
GAL	1	FG001A0004				
BLK	1 1/4	FS001A0005	76	76	57	
GAL	1 1/4	FG001A0005				
BLK	1 1/2	FS001A0006	85	85	66	
GAL	1 1/2	FG001A0006				
BLK	2	FS001A0007	102	102	78	
GAL	2	FG001A0007				

Size	Code	Index	Bag	Carton	Gr
BLK 1/2	FS00020002	4,35	10	160	140
GAL 1/2	FG00020002	5,45	10	160	145
BLK 3/4	FS00020003	6,85	10	80	255
GAL 3/4	FG00020003	8,45	10	80	270
BLK 1	FS00020004	9,00		50	385
GAL 1	FG00020004	11,40		50	415
BLK 1 1/4	FS00020005	16,00		30	620
GAL 1 1/4	FG00020005	19,90		30	650
BLK 1 1/2	FS00020006	19,75		20	770
GAL 1 1/2	FG00020006	24,40		20	820
BLK 2	FS00020007	27,20		10	1550
GAL 2	FG00020007	33,95		10	1605
BLK 3	FS00020009	95,00		3	3970
GAL 3	FG00020009	120,20		3	4100

Dimension	Code	a	b	z	z1
BLK 1/2	FS00020002	55		42	
GAL 1/2	FG00020002				
BLK 3/4	FS00020003	69		54	
GAL 3/4	FG00020003				
BLK 1	FS00020004	85		68	
GAL 1	FG00020004				
BLK 1 1/4	FS00020005	105		86	
GAL 1 1/4	FG00020005				
BLK 1 1/2	FS00020006	116		97	
GAL 1 1/2	FG00020006				
BLK 2	FS00020007	140		116	
GAL 2	FG00020007				
BLK 3	FS00020009	205		175	
GAL 3	FG00020009				



2
ISO/EN(G1)

Long sweep bend

Langer bogen

Courbe à grand rayon

Curva lunga

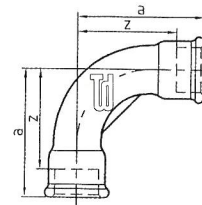

Size	Code	Index	Bag	Carton	Gr
BLK 1/2	FS002A0002	3,30	10	160	140
GAL 1/2	FG002A0002	4,20	10	160	145
BLK 3/4	FS002A0003	4,45	10	80	235
GAL 3/4	FG002A0003	5,80	10	80	245
BLK 1	FS002A0004	7,00		50	385
GAL 1	FG002A0004	9,00		50	395
BLK 1 1/4	FS002A0005	10,40		30	645
GAL 1 1/4	FG002A0005	13,50		30	675
BLK 1 1/2	FS002A0006	14,30		20	830
GAL 1 1/2	FG002A0006	18,15		20	865
BLK 2	FS002A0007	22,55		10	1415
GAL 2	FG002A0007	29,25		10	1455
BLK 3	FS002A0009	73,25		4	2565
GAL 3	FG002A0009	92,75		4	2660

Dimension	Code	a	b	z	z1
BLK 1/2	FS002A0002	45		32	
GAL 1/2	FG002A0002				
BLK 3/4	FS002A0003	50		35	
GAL 3/4	FG002A0003				
BLK 1	FS002A0004	63		46	
GAL 1	FG002A0004				
BLK 1 1/4	FS002A0005	76		57	
GAL 1 1/4	FG002A0005				
BLK 1 1/2	FS002A0006	85		66	
GAL 1 1/2	FG002A0006				
BLK 2	FS002A0007	102		78	
GAL 2	FG002A0007				
BLK 3	FS002A0009	127		97	
GAL 3	FG002A0009				



2a
ISO/EN(D1)

Short bend

Kurzer bogen

Courbe courte

Curva corta

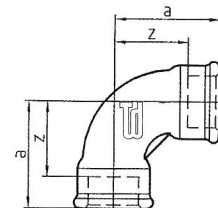

3

ISO/EN (G8)

Long sweep bend

Langer bogen

Courbe à grand rayon

Curva lunga

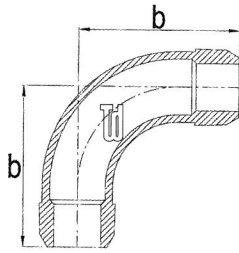

Size	Code	Index	Bag	Carton	Gr
BLK 1/2	FS00030002	6,65	10	180	95
GAL 1/2	FG00030002	8,35	10	180	100
BLK 3/4	FS00030003	7,45	10	100	175
GAL 3/4	FG00030003	9,40	10	100	190
BLK 1	FS00030004	10,80		60	340
GAL 1	FG00030004	13,45		60	360
BLK 1 1/4	FS00030005	20,30		30	540
GAL 1 1/4	FG00030005	25,80		30	575
BLK 1 1/2	FS00030006	29,00		25	740
GAL 1 1/2	FG00030006	36,55		25	780
BLK 2	FS00030007	39,00		12	1400
GAL 2	FG00030007	49,35		12	1460

Dimension	Code	a	b	z	z1
BLK 1/2	FS00030002		48		
GAL 1/2	FG00030002				
BLK 3/4	FS00030003		60		
GAL 3/4	FG00030003				
BLK 1	FS00030004		75		
GAL 1	FG00030004				
BLK 1 1/4	FS00030005		95		
GAL 1 1/4	FG00030005				
BLK 1 1/2	FS00030006		105		
GAL 1 1/2	FG00030006				
BLK 2	FS00030007		130		
GAL 2	FG00030007				

40

ISO/EN (G4/45°)

45° Long sweep bend

Langer bogen 45°

Courbe à grand rayon 45°

Curva lunga 45°

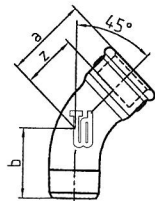

Size	Code	Index	Bag	Carton	Gr
BLK 1/2	FS00400002	4,35	10	180	110
GAL 1/2	FG00400002	5,45	10	180	115
BLK 3/4	FS00400003	5,90	10	100	175
GAL 3/4	FG00400003	7,35	10	100	180
BLK 1	FS00400004	8,40	10	60	280
GAL 1	FG00400004	10,35	10	60	295
BLK 1 1/4	FS00400005	14,50		30	575
GAL 1 1/4	FG00400005	18,05		30	605
BLK 1 1/2	FS00400006	17,40		25	620
GAL 1 1/2	FG00400006	21,55		25	655
BLK 2	FS00400007	27,45		12	1050
GAL 2	FG00400007	34,15		12	1110

Dimension	Code	a	b	z	z1
BLK 1/2	FS00400002	36	30	23	
GAL 1/2	FG00400002				
BLK 3/4	FS00400003	43	36	28	
GAL 3/4	FG00400003				
BLK 1	FS00400004	51	42	34	
GAL 1	FG00400004				
BLK 1 1/4	FS00400005	64	54	45	
GAL 1 1/4	FG00400005				
BLK 1 1/2	FS00400006	68	58	49	
GAL 1 1/2	FG00400006				
BLK 2	FS00400007	81	70	57	
GAL 2	FG00400007				

Size	Code	Index	Bag	Carton	Gr
BLK 1/2	FS00410002	5,30	10	160	140
GAL 1/2	FG00410002	6,50	10	160	145
BLK 3/4	FS00410003	6,55	10	80	220
GAL 3/4	FG00410003	8,20	10	80	235
BLK 1	FS00410004	8,50	10	50	330
GAL 1	FG00410004	10,50	10	50	350
BLK 1 1/4	FS00410005	15,05		30	575
GAL 1 1/4	FG00410005	19,00		30	620
BLK 1 1/2	FS00410006	19,80		20	730
GAL 1 1/2	FG00410006	25,05		20	760
BLK 2	FS00410007	28,00		10	1310
GAL 2	FG00410007	35,20		10	1355

Dimension	Code	a	b	z	z1
BLK 1/2	FS00410002	36		23	
GAL 1/2	FG00410002				
BLK 3/4	FS00410003	43		28	
GAL 3/4	FG00410003				
BLK 1	FS00410004	51		34	
GAL 1	FG00410004				
BLK 1 1/4	FS00410005	64		45	
GAL 1 1/4	FG00410005				
BLK 1 1/2	FS00410006	68		49	
GAL 1 1/2	FG00410006				
BLK 2	FS00410007	81		57	
GAL 2	FG00410007				



41
ISO/EN (G1/45°)

45° Long sweep bend

Langer bogen 45°

Courbe à grand rayon 45°

Curva lunga 45°

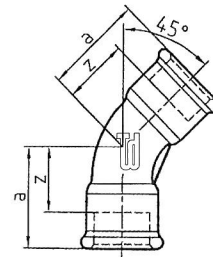

Size	Code	Index	Bag	Carton	Gr
BLK 1/2	FS00850002	5,55	10	100	185
GAL 1/2	FG00850002	7,00	10	100	200
BLK 3/4	FS00850003	8,50	10	70	295
GAL 3/4	FG00850003	10,50	10	70	315
BLK 1	FS00850004	16,95		40	505
GAL 1	FG00850004	21,95		40	535

Dimension	Code	a	d	z	z1
BLK 1/2	FS00850002	48	0.5in.	36	
GAL 1/2	FG00850002				
BLK 3/4	FS00850003	60	0.75in.	45	
GAL 3/4	FG00850003				
BLK 1	FS00850004	70	1in.	53	
GAL 1	FG00850004				



85

Crossover

Überspringbogen

Dos d'âne

Scavalcatubo a curva

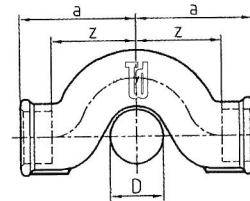

87

Tee, with crossover branch

Überspring-T
Té à dos d'âne

Scavalcatubo a ti

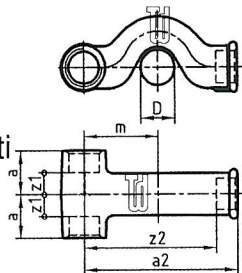

Dimension	Code	Index	Bag	Carton	Gr
BLK 1/2 "	FS00870002	13,15	10	80	220
GLV 1/2 "	FG00870002	17,80	10	80	230

Dimension	Code	a	b	z	z1	D
BLK 1/2 "	FS00870002	26	93	13	80	0,5 in.
GLV 1/2 "	FG00870002	26	93	13	80	0,5 in.

90

ISO/EN(A1)

Elbow

Winkel

Coude

Gomito

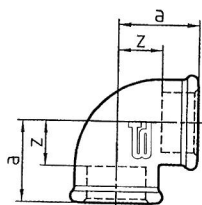

Dimension	Code	Index	Bag	Carton	Gr
BLK 3/8 "	FS00900001	1,95	10	350	70
GLV 3/8 "	FG00900001	2,50	10	350	75
BLK 1/2 "	FS00900002	1,30	10	270	85
GLV 1/2 "	FG00900002	1,75	10	270	90
BLK 3/4 "	FS00900003	2,10	10	150	150
GLV 3/4 "	FG00900003	2,75	10	150	155
BLK 1 "	FS00900004	3,25	10	100	230
GLV 1 "	FG00900004	4,10	10	100	245
BLK 1 1/4 "	FS00900005	6,10		60	355
GLV 1 1/4 "	FG00900005	7,65		60	370
BLK 1 1/2 "	FS00900006	9,90		35	590
GLV 1 1/2 "	FG00900006	12,35		35	610
BLK 2 "	FS00900007	11,40		20	905
GLV 2 "	FG00900007	14,50		20	945
BLK 2 1/2 "	FS00900008	33,60		12	1.285
GLV 2 1/2 "	FG00900008	42,50		12	1.385
BLK 3 "	FS00900009	46,80		8	1.895
GLV 3 "	FG00900009	58,25		8	1.980
BLK 4 "	FS00900000	82,55		4	3.225
GLV 4 "	FG00900000	104,40		4	3.355

Dimension	Code	a	b	z	z1
BLK 3/8 "	FS00900001	25		15	
GLV 3/8 "	FG00900001				
BLK 1/2 "	FS00900002	28		15	
GLV 1/2 "	FG00900002				
BLK 3/4 "	FS00900003	33		18	
GLV 3/4 "	FG00900003				
BLK 1 "	FS00900004	38		21	
GLV 1 "	FG00900004				
BLK 1 1/4 "	FS00900005	45		26	
GLV 1 1/4 "	FG00900005				
BLK 1 1/2 "	FS00900006	50		31	
GLV 1 1/2 "	FG00900006				
BLK 2 "	FS00900007	58		34	
GLV 2 "	FG00900007				
BLK 2 1/2 "	FS00900008	69		42	
GLV 2 1/2 "	FG00900008				
BLK 3 "	FS00900009	78		48	
GLV 3 "	FG00900009				
BLK 4 "	FS00900000	96		60	
GLV 4 "	FG00900000				

Dimension	Code	Index	Bag	Carton	Gr
BLK 3/4-1/2 "	FS090R0032	3.05	10	150	155
GLV 3/4-1/2 "	FG090R0032	3.65	10	150	165
BLK 1-3/8 "	FS090R0041	5.25	10	120	195
GLV 1-3/8 "	FG090R0041	6.30	10	120	205
BLK 1-1/2 "	FS090R0042	4.10	10	120	195
GLV 1-1/2 "	FG090R0042	5.30	10	120	200
BLK 1-3/4 "	FS090R0043	4.50	10	100	215
GLV 1-3/4 "	FG090R0043	5.60	10	100	230
BLK 1 1/4-1/2 "	FS090R0052	6.95	45	45	290
GLV 1 1/4-1/2 "	FG090R0052	8.45	45	45	305
BLK 1 1/4-3/4 "	FS090R0053	9.20	45	45	330
GLV 1 1/4-3/4 "	FG090R0053	11.40	45	45	350
BLK 1 1/4-1 "	FS090R0054	7.25	40	40	375
GLV 1 1/4-1 "	FG090R0054	9.05	40	40	400
BLK 1 1/2-3/4 "	FS090R0063	11.25	40	40	400
GLV 1 1/2-3/4 "	FG090R0063	14.00	40	40	420
BLK 1 1/2-1 "	FS090R0064	10.40	40	40	445
GLV 1 1/2-1 "	FG090R0064	13.25	40	40	470
BLK 1 1/2-1 1/4 "	FS090R0065	11.70	40	40	470
GLV 1 1/2-1 1/4 "	FG090R0065	14.50	40	40	485
BLK 2-1 "	FS090R0074	18.45	35	35	700
GLV 2-1 "	FG090R0074	23.00	35	35	740
BLK 2-1 1/4 "	FS090R0075	19.80	35	35	590
GLV 2-1 1/4 "	FG090R0075	24.95	35	35	635
BLK 2-1 1/2 "	FS090R0076	18.80	30	30	710
GLV 2-1 1/2 "	FG090R0076	23.35	30	30	750

90R
ISO/EN (A1)
Elbow
Winkel
Coude
Gomito



Dimension	Code	a	b	z1	z2
BLK 3/4-1/2 "	FS090R0032	30	31	15	18
GLV 3/4-1/2 "	FG090R0032				
BLK 1-3/8 "	FS090R0041	32	34	12	21
GLV 1-3/8 "	FG090R0041				
BLK 1-1/2 "	FS090R0042	32	34	15	21
GLV 1-1/2 "	FG090R0042				
BLK 1-3/4 "	FS090R0043	35	36	18	21
GLV 1-3/4 "	FG090R0043				
BLK 1 1/4-1/2 "	FS090R0052	34	38	15	25
GLV 1 1/4-1/2 "	FG090R0052				
BLK 1 1/4-3/4 "	FS090R0053	36	41	17	26
GLV 1 1/4-3/4 "	FG090R0053				
BLK 1 1/4-1 "	FS090R0054	40	42	21	25
GLV 1 1/4-1 "	FG090R0054				
BLK 1 1/2-3/4 "	FS090R0063	38	44	19	29
GLV 1 1/2-3/4 "	FG090R0063				
BLK 1 1/2-1 "	FS090R0064	42	46	23	29
GLV 1 1/2-1 "	FG090R0064				
BLK 1 1/2-1 1/4 "	FS090R0065	46	48	27	29
GLV 1 1/2-1 1/4 "	FG090R0065				
BLK 2-1 "	FS090R0074	46	53	22	36
GLV 2-1 "	FG090R0074				
BLK 2-1 1/4 "	FS090R0075	48	53	24	33
GLV 2-1 1/4 "	FG090R0075				
BLK 2-1 1/2 "	FS090R0076	52	55	28	36
GLV 2-1 1/2 "	FG090R0076				

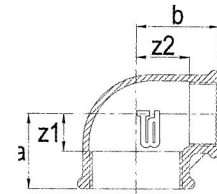

**92**

ISO/EN (A4)

Elbow

Winkel

Coude

Gomito



Dimension	Code	Index	Bag	Carton	Gr
BLK 3/8 "	FS00920001	2,35	10	350	60
GLV 3/8 "	FG00920001	2,85	10	350	65
BLK 1/2 "	FS00920002	1,65	10	250	100
GLV 1/2 "	FG00920002	2,05	10	250	110
BLK 3/4 "	FS00920003	2,55	10	150	160
GLV 3/4 "	FG00920003	3,20	10	150	165
BLK 1 "	FS00920004	4,15	10	90	255
GLV 1 "	FG00920004	5,30	10	90	265
BLK 1 1/4 "	FS00920005	7,30		50	420
GLV 1 1/4 "	FG00920005	8,95		50	435
BLK 1 1/2 "	FS00920006	10,70		40	600
GLV 1 1/2 "	FG00920006	13,40		40	620
BLK 2 "	FS00920007	13,95		20	880
GLV 2 "	FG00920007	17,65		20	920
BLK 2 1/2 "	FS00920008	35,25		12	1.520
GLV 2 1/2 "	FG00920008	43,85		12	1.565
BLK 3 "	FS00920009	46,40		8	2.080
GLV 3 "	FG00920009	57,80		8	2.160
BLK 4 "	FS00920000	78,00		4	3.030
GLV 4 "	FG00920000	98,70		4	3.130

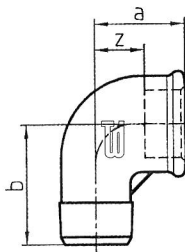

Dimension	Code	a	b	c	z
BLK 3/8 "	FS00920001	25	32		15
GLV 3/8 "	FG00920001				
BLK 1/2 "	FS00920002	28	37		15
GLV 1/2 "	FG00920002				
BLK 3/4 "	FS00920003	33	43		18
GLV 3/4 "	FG00920003				
BLK 1 "	FS00920004	38	52		21
GLV 1 "	FG00920004				
BLK 1 1/4 "	FS00920005	45	60		26
GLV 1 1/4 "	FG00920005				
BLK 1 1/2 "	FS00920006	50	65		31
GLV 1 1/2 "	FG00920006				
BLK 2 "	FS00920007	58	74		34
GLV 2 "	FG00920007				
BLK 2 1/2 "	FS00920008	69	88		42
GLV 2 1/2 "	FG00920008				
BLK 3 "	FS00920009	78	98		48
GLV 3 "	FG00920009				
BLK 4 "	FS00920000	96	118		60
GLV 4 "	FG00920000				

92R

ISO/EN (A4)

Elbow

Winkel

Coude

Gomito

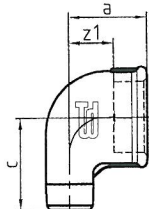

Dimension	Code	Index	Bag	Carton	Gr
BLK 3/4-1/2 "	FS092R0032	6,40		150	125
GLV 3/4-1/2 "	FG092R0032	8,05		150	130

Dimension	Code	a	b	c	z	z1
BLK 3/4-1/2 "	FS092R0032	30		40		18
GLV 3/4-1/2 "	FG092R0032					

Dimension	Code	Index	Bag	Carton	Gr
BLK 1/2 "	FS00950002	9,35	10	90	260
GLV 1/2 "	FG00950002	11,60	10	90	265
BLK 3/4 "	FS00950003	10,30	10	50	380
GLV 3/4 "	FG00950003	12,75	10	50	390
BLK 1 "	FS00950004	12,70	40	40	450
GLV 1 "	FG00950004	15,95	40	40	475

Dimension	Code	a	c	z1	z2	s1
BLK 1/2 "	FS00950002	58	28	15	45	26
GLV 1/2 "	FG00950002					
BLK 3/4 "	FS00950003	62	33	18	47	31
GLV 3/4 "	FG00950003					
BLK 1 "	FS00950004	72	38	21	55	38
GLV 1 "	FG00950004					



95
ISO/EN (UA1)

Union elbows,
flat seat

Winkelverschraubung,
flach
dichtend

Coude union à
joint plat

Gomito con
bocchettone a
sede piana

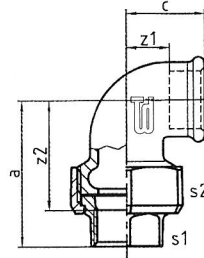

Dimension	Code	Index	Bag	Carton	Gr
BLK 1/2 "	FS00960002	9,30	10	90	260
GLV 1/2 "	FG00960002	11,75	10	90	270
BLK 3/4 "	FS00960003	10,75	10	50	390
GLV 3/4 "	FG00960003	13,60	10	50	405
BLK 1 "	FS00960004	15,55	40	40	455
GLV 1 "	FG00960004	19,55	40	40	480

Dimension	Code	a	c	z1	z2	s1
BLK 1/2 "	FS00960002	58	28	15	45	25
GLV 1/2 "	FG00960002					
BLK 3/4 "	FS00960003	62	33	18	47	32
GLV 3/4 "	FG00960003					
BLK 1 "	FS00960004	72	38	21	55	38
GLV 1 "	FG00960004					



96
ISO/EN (UA11)

Union elbow,
taper seat

Winkelverschraubung
mit Kegeldichtung

Coude union
à joint conique

Gomito
con bocchettone
a sede
conica

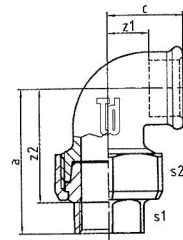

Dimension	Code	Index	Bag	Carton	Gr
BLK 1/2 "	FS00970002	9,45	10	80	270
GLV 1/2 "	FG00970002	11,95	10	80	280
BLK 3/4 "	FS00970003	11,35	10	50	400
GLV 3/4 "	FG00970003	14,35	10	50	420
BLK 1 "	FS00970004	14,35	40	40	510
GLV 1 "	FG00970004	18,25	40	40	545

Dimension	Code	b	c	z1	s1	s2
BLK 1/2 "	FS00970002	76	28	15	25	41
GLV 1/2 "	FG00970002					
BLK 3/4 "	FS00970003	82	33	18	31	50
GLV 3/4 "	FG00970003					
BLK 1 "	FS00970004	93	38	21	38	55
GLV 1 "	FG00970004					



97
ISO/EN (UA2)

Union elbow,
flat seat

Winkelverschraubung,
flach
dichtend

Coude union
à joint plat

Gomito con
bocchettone
a sede piana

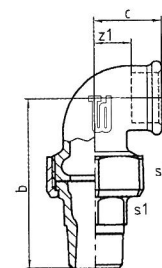

98

ISO/EN(UA12)

Union elbow,
taper seat

Winkelverschrau-
bung mit
Kegeldichtung

Coude union à
joint conique

Gomito con
bocchettone a
sede conica

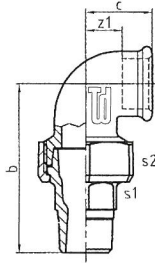

Dimension	Code	Index	Bag	Carton	Gr
BLK 1/2 "	FS00980002	9,35	10	80	275
GLV 1/2 "	FG00980002	11,80	10	80	290
BLK 3/4 "	FS00980003	11,95	10	50	405
GLV 3/4 "	FG00980003	15,00	10	50	425
BLK 1 "	FS00980004	16,35		40	510
GLV 1 "	FG00980004	20,55		40	565

Dimension	Code	b	c	z1	s1	s2
BLK 1/2 "	FS00980002	76	28	15	25	41
GLV 1/2 "	FG00980002					
BLK 3/4 "	FS00980003	82	33	18	31	50
GLV 3/4 "	FG00980003					
BLK 1 "	FS00980004	94	38	21	38	55
GLV 1 "	FG00980004					

120

ISO/EN (A1/45°)

45° Elbow

Winkel 45°

Coude 45°

Gomito 45°



Dimension	Code	Index	Bag	Carton	Gr
BLK 1/2 "	FS01200002	4,45	10	300	80
GLV 1/2 "	FG01200002	5,70	10	300	85
BLK 3/4 "	FS01200003	5,55	10	150	150
GLV 3/4 "	FG01200003	7,05	10	150	160
BLK 1 "	FS01200004	8,20		100	240
GLV 1 "	FG01200004	10,35		100	255
BLK 1 1/4 "	FS01200005	14,75		50	400
GLV 1 1/4 "	FG01200005	18,80		50	420
BLK 1 1/2 "	FS01200006	18,15		40	465
GLV 1 1/2 "	FG01200006	22,95		40	490
BLK 2 "	FS01200007	23,70		20	850
GLV 2 "	FG01200007	30,00		20	880
BLK 2 1/2 "	FS01200008	49,00		12	900
GLV 2 1/2 "	FG01200008	61,95		12	950

Dimension	Code	a	z
BLK 1/2 "	FS01200002	22	9
GLV 1/2 "	FG01200002		
BLK 3/4 "	FS01200003	25	10
GLV 3/4 "	FG01200003		
BLK 1 "	FS01200004	28	11
GLV 1 "	FG01200004		
BLK 1 1/4 "	FS01200005	33	14
GLV 1 1/4 "	FG01200005		
BLK 1 1/2 "	FS01200006	36	17
GLV 1 1/2 "	FG01200006		
BLK 2 "	FS01200007	43	19
GLV 2 "	FG01200007		
BLK 2 1/2 "	FS01200008	48	21
GLV 2 1/2 "	FG01200008		

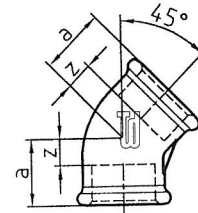

121

ISO/EN (A4/45°)

45° Elbow

Winkel 45°

Coude 45°

Gomito 45°



Dimension	Code	Index	Bag	Carton	Gr
BLK 1/2 "	FS01210002	4,10	10	300	80
GLV 1/2 "	FG01210002	5,25	10	300	85
BLK 3/4 "	FS01210003	5,35	10	150	135
GLV 3/4 "	FG01210003	6,65	10	150	140
BLK 1 "	FS01210004	8,20	10	100	200
GLV 1 "	FG01210004	10,35	10	100	210
BLK 1 1/4 "	FS01210005	15,20		50	340
GLV 1 1/4 "	FG01210005	19,30		50	355
BLK 1 1/2 "	FS01210006	16,50		40	455
GLV 1 1/2 "	FG01210006	20,85		40	475
BLK 2 "	FS01210007	20,95		20	770
GLV 2 "	FG01210007	26,40		20	800

Dimension	Code	a	b	z
BLK 1/2 "	FS01210002	22	28	9
GLV 1/2 "	FG01210002			
BLK 3/4 "	FS01210003	25	32	10
GLV 3/4 "	FG01210003			
BLK 1 "	FS01210004	28	37	11
GLV 1 "	FG01210004			
BLK 1 1/4 "	FS01210005	33	43	14
GLV 1 1/4 "	FG01210005			
BLK 1 1/2 "	FS01210006	36	46	17
GLV 1 1/2 "	FG01210006			
BLK 2 "	FS01210007	43	55	19
GLV 2 "	FG01210007			

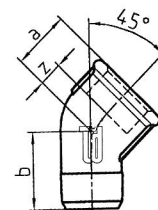

130

ISO/EN(B1)

Tee

T-Stück

Té

Ti

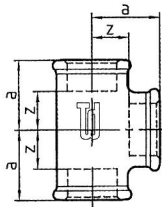

Dimension	Code	Index	Bag	Carton	Gr
BLK 3/8 "	FS01300001	2,85	10	240	95
GLV 3/8 "	FG01300001	3,50	10	240	100
BLK 1/2 "	FS01300002	1,90	10	180	125
GLV 1/2 "	FG01300002	2,40	10	180	130
BLK 3/4 "	FS01300003	3,25	10	100	210
GLV 3/4 "	FG01300003	4,10	10	100	220
BLK 1 "	FS01300004	4,70	10	60	320
GLV 1 "	FG01300004	6,00	10	60	335
BLK 1 1/4 "	FS01300005	8,40		35	520
GLV 1 1/4 "	FG01300005	10,40		35	530
BLK 1 1/2 "	FS01300006	12,85		25	690
GLV 1 1/2 "	FG01300006	16,10		25	710
BLK 2 "	FS01300007	18,45		15	1.130
GLV 2 "	FG01300007	22,70		15	1.180
BLK 2 1/2 "	FS01300008	41,70		8	1.685
GLV 2 1/2 "	FG01300008	51,90		8	1.790
BLK 3 "	FS01300009	55,80		6	2.265
GLV 3 "	FG01300009	69,30		6	2.350
BLK 4 "	FS01300000	107,35		3	4.070
GLV 4 "	FG01300000	135,90		3	4.355

Dimension	Code	a	z
BLK 3/8 "	FS01300001	25	15
GLV 3/8 "	FG01300001		
BLK 1/2 "	FS01300002	28	15
GLV 1/2 "	FG01300002		
BLK 3/4 "	FS01300003	33	18
GLV 3/4 "	FG01300003		
BLK 1 "	FS01300004	38	21
GLV 1 "	FG01300004		
BLK 1 1/4 "	FS01300005	45	26
GLV 1 1/4 "	FG01300005		
BLK 1 1/2 "	FS01300006	50	31
GLV 1 1/2 "	FG01300006		
BLK 2 "	FS01300007	58	34
GLV 2 "	FG01300007		
BLK 2 1/2 "	FS01300008	69	42
GLV 2 1/2 "	FG01300008		
BLK 3 "	FS01300009	78	48
GLV 3 "	FG01300009		
BLK 4 "	FS01300000	96	60
GLV 4 "	FG01300000		

130R

ISO/EN(B1)

Tee
T-Stück
Té
Ti

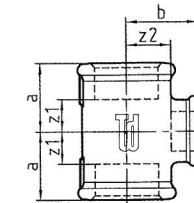
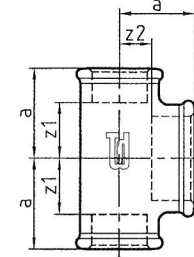
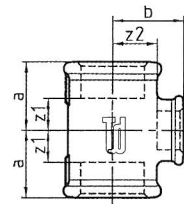

Dimension	Code	Index	Bag	Carton	Gr
BLK 1/2-3/4-1/2 "	FS130R0232	4,05	10	130	160
GLV 1/2-3/4-1/2 "	FG130R0232	5,15	10	130	165
BLK 3/4-1/2-1/2 "	FS130R0322	3,65	10	130	155
LV 3/4-1/2-1/2 "	FG130R0322	4,55	10	130	160
BLK 3/4-1/2-3/4 "	FS130R0323	3,35	10	100	180
GLV 3/4-1/2-3/4 "	FG130R0323	4,25	10	100	190
BLK 3/4-3/4-1/2 "	FS130R0332	4,25	10	100	175
GLV 3/4-3/4-1/2 "	FG130R0332	5,40	10	100	180
BLK 3/4-1-1/2 "	FS130R0342	8,40	10	80	235
GLV 3/4-1-1/2 "	FG130R0342	10,55	10	80	245
BLK 3/4-1-3/4 "	FS130R0343	7,15	10	80	240
GLV 3/4-1-3/4 "	FG130R0343	8,75	10	80	250
BLK 1-1/2-1/2 "	FS130R0422	7,75	10	100	195
GLV 1-1/2-1/2 "	FG130R0422	9,55	10	100	205
BLK 1-1/2-3/4 "	FS130R0423	5,40	10	100	200
GLV 1-1/2-3/4 "	FG130R0423	6,80	10	100	210
BLK 1-3/8-1 "	FS130R0414	7,50	10	100	270
GLV 1-3/8-1 "	FG130R0414	9,50	10	100	280
BLK 1-1/2-1 "	FS130R0424	4,40	10	90	210
GLV 1-1/2-1 "	FG130R0424	5,55	10	90	220
BLK 1-3/4-1/2 "	FS130R0432	6,95	10	80	225
GLV 1-3/4-1/2 "	FG130R0432	8,70	10	80	235
BLK 1-3/4-3/4 "	FS130R0433	5,50	10	80	230
GLV 1-3/4-3/4 "	FG130R0433	6,95	10	80	240
BLK 1-3/4-1 "	FS130R0434	4,80	10	70	260
GLV 1-3/4-1 "	FG130R0434	6,00	10	70	275
BLK 1-1 1/4-3/4 "	FS130R0453	13,05		50	310
GLV 1-1 1/4-3/4 "	FG130R0453	16,35		50	320
BLK 1-1 1/4-1 "	FS130R0454	11,00		50	415
GLV 1-1 1/4-1 "	FG130R0454	13,85		50	430
BLK 1 1/4-3/8-1 1/4 "	FS130R0515	10,90		30	385
GLV 1 1/4-3/8-1 1/4 "	FG130R0515	13,70		30	400
BLK 1 1/4-1/2-1 "	FS130R0524	8,65		55	300
GLV 1 1/4-1/2-1 "	FG130R0524	10,80		55	310
BLK 1 1/4-1/2-1 1/4 "	FS130R0525	7,35		55	300
GLV 1 1/4-1/2-1 1/4 "	FG130R0525	9,30		55	315
BLK 1 1/4-3/4-1 "	FS130R0534	10,15		48	330
GLV 1 1/4-3/4-1 "	FG130R0534	12,60		48	340
BLK 1 1/4-3/4-1 1/4 "	FS130R0535	8,00		55	345
GLV 1 1/4-3/4-1 1/4 "	FG130R0535	9,80		55	360
BLK 1 1/4-1-3/4 "	FS130R0543	11,70		48	380
GLV 1 1/4-1-3/4 "	FG130R0543	14,70		48	395
BLK 1 1/4-1-1 "	FS130R0544	9,90		36	410
GLV 1 1/4-1-1 "	FG130R0544	12,30		36	425
BLK 1 1/4-1-1 1/4 "	FS130R0545	8,75		50	380
GLV 1 1/4-1-1 1/4 "	FG130R0545	11,00		50	390
BLK 1 1/4-1 1/4-1 "	FS130R0554	11,00		50	495
GLV 1 1/4-1 1/4-1 "	FG130R0554	14,00		50	520
BLK 1 1/4-1 1/2-1 1/4 "	FS130R0565	17,25		30	645
GLV 1 1/4-1 1/2-1 1/4 "	FG130R0565	21,80		30	670
BLK 1 1/2-1/2-1 1/2 "	FS130R0626	9,90		45	385
GLV 1 1/2-1/2-1 1/2 "	FG130R0626	12,45		45	395
BLK 1 1/2-3/4-1 1/2 "	FS130R0636	10,65		45	425
GLV 1 1/2-3/4-1 1/2 "	FG130R0636	13,50		45	440
BLK 1 1/2-1-1 1/4 "	FS130R0645	13,10		32	530
GLV 1 1/2-1-1 1/4 "	FG130R0645	16,50		32	545
BLK 1 1/2-1-1 1/2 "	FS130R0646	11,60		30	510
GLV 1 1/2-1-1 1/2 "	FG130R0646	14,60		30	535
BLK 1 1/2-1 1/4-1 1/4 "	FS130R0655	16,05		30	625
GLV 1 1/2-1 1/4-1 1/4 "	FG130R0655	20,50		30	650
BLK 1 1/2-1 1/4-1 1/2 "	FS130R0656	15,70		30	555
GLV 1 1/2-1 1/4-1 1/2 "	FG130R0656	19,90		30	580
BLK 1 1/2-3/4-1 1/4 "	FS130R0635	15,00		32	434
GLV 1 1/2-3/4-1 1/4 "	FG130R0635	19,05		32	440
BLK 2-1/2-2 "	FS130R0727	14,55		20	790
GLV 2-1/2-2 "	FG130R0727	18,40		20	840
BLK 2-3/4-2 "	FS130R0737	18,95		20	775
GLV 2-3/4-2 "	FG130R0737	24,00		20	820

130R

ISO/EN(B1)

Tee

T-Stück

Té

Ti

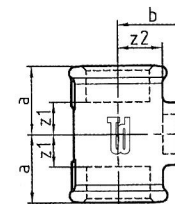
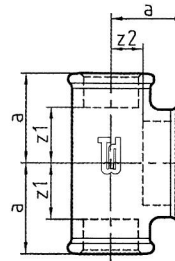
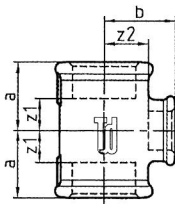

BLK	2-1-1 1/2 "	FS130R0746	20,90	20	690
GLV	2-1-1 1/2 "	FG130R0746	26,30	20	725
BLK	2-1-2 "	FS130R0747	14,90	20	850
GLV	2-1-2 "	FG130R0747	18,60	20	925
BLK	2-1 1/4-1 1/2 "	FS130R0756	20,80	20	880
GLV	2-1 1/4-1 1/2 "	FG130R0756	26,10	20	915
BLK	2-1 1/4-2 "	FS130R0757	18,95	20	860
GLV	2-1 1/4-2 "	FG130R0757	24,00	20	890
BLK	2-1 1/2-2 "	FS130R0767	22,20	20	840
GLV	2-1 1/2-2 "	FG130R0767	27,65	20	875
BLK	2-2-1 "	FS130R0774	22,35	20	1.030
GLV	2-2-1 "	FG130R0774	28,20	20	1.070
BLK	2 1/2-2-2 1/2 "	FS130R0878	40,50	12	1.340
GLV	2 1/2-2-2 1/2 "	FG130R0878	51,15	12	1.420
BLK	3-2-3 "	FS130R0979	55,35	8	2.235
GLV	3-2-3 "	FG130R0979	66,85	8	2.315

130R

ISO/EN(B1)

Tee
T-Stück
Té
Ti

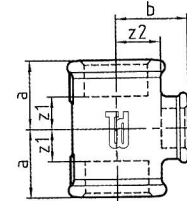
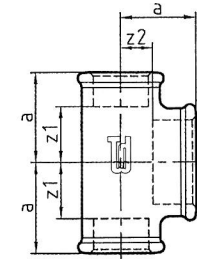
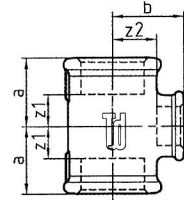

Dimension	Code	a	b	c	z1	z2
BLK 1/2-3/4-1/2 "	FS130R0232	31	30		18	15
GLV 1/2-3/4-1/2 "	FG130R0232					
BLK 3/4-1/2-1/2 "	FS130R0322	30	31	28	15	18
GLV 3/4-1/2-1/2 "	FG130R0322					
BLK 3/4-1/2-3/4 "	FS130R0323	30	31		15	18
GLV 3/4-1/2-3/4 "	FG130R0323					
BLK 3/4-3/4-1/2 "	FS130R0332	33	33	31	18	18
GLV 3/4-3/4-1/2 "	FG130R0332					
BLK 3/4-1-1/2 "	FS130R0342	36	35	34	21	18
GLV 3/4-1-1/2 "	FG130R0342					
BLK 3/4-1-3/4 "	FS130R0343	36	35		21	18
GLV 3/4-1-3/4 "	FG130R0343					
BLK 1-1/2-1/2 "	FS130R0422	32	34	28	15	21
GLV 1-1/2-1/2 "	FG130R0422					
BLK 1-1/2-3/4 "	FS130R0423	32	34	30	15	21
GLV 1-1/2-3/4 "	FG130R0423					
BLK 1-3/8-1 "	FS130R0414	30	32		13	22
GLV 1-3/8-1 "	FG130R0414					
BLK 1-1/2-1 "	FS130R0424	32	34		15	21
GLV 1-1/2-1 "	FG130R0424					
BLK 1-3/4-1/2 "	FS130R0432	35	36	31	18	21
GLV 1-3/4-1/2 "	FG130R0432					
BLK 1-3/4-3/4 "	FS130R0433	35	36	33	18	21
GLV 1-3/4-3/4 "	FG130R0433					
BLK 1-3/4-1 "	FS130R0434	35	36		18	21
GLV 1-3/4-1 "	FG130R0434					
BLK 1-1 1/4-3/4 "	FS130R0453	42	40	41	25	21
GLV 1-1 1/4-3/4 "	FG130R0453					
BLK 1-1 1/4-1 "	FS130R0454	42	40		25	21
GLV 1-1 1/4-1 "	FG130R0454					
BLK 1 1/4-3/8-1 1/4 "	FS130R0515	32	36		15	27
GLV 1 1/4-3/8-1 1/4 "	FG130R0515					
BLK 1 1/4-1/2-1 "	FS130R0524	34	38	32	15	25
GLV 1 1/4-1/2-1 "	FG130R0524					
BLK 1 1/4-1/2-1 1/4 "	FS130R0525	34	38		15	25
GLV 1 1/4-1/2-1 1/4 "	FG130R0525					
BLK 1 1/4-3/4-1 "	FS130R0534	36	41	35	17	26
GLV 1 1/4-3/4-1 "	FG130R0534					
BLK 1 1/4-3/4-1 1/4 "	FS130R0535	36	41		17	26
GLV 1 1/4-3/4-1 1/4 "	FG130R0535					
BLK 1 1/4-1-3/4 "	FS130R0543	40	42	36	21	25
GLV 1 1/4-1-3/4 "	FG130R0543					
BLK 1 1/4-1-1 "	FS130R0544	40	42	38	21	25
GLV 1 1/4-1-1 "	FG130R0544					
BLK 1 1/4-1-1 1/4 "	FS130R0545	40	42		21	25
GLV 1 1/4-1-1 1/4 "	FG130R0545					
BLK 1 1/4-1 1/4-1 "	FS130R0554	45	45	42	26	26
GLV 1 1/4-1 1/4-1 "	FG130R0554					
BLK 1 1/4-1 1/2-1 1/4 "	FS130R0565	48	46		29	27
GLV 1 1/4-1 1/2-1 1/4 "	FG130R0565					
BLK 1 1/2-1/2-1 1/2 "	FS130R0626	36	42		17	29
GLV 1 1/2-1/2-1 1/2 "	FG130R0626					
BLK 1 1/2-3/4-1 1/2 "	FS130R0636	38	44		19	29
GLV 1 1/2-3/4-1 1/2 "	FG130R0636					
BLK 1 1/2-1-1 1/4 "	FS130R0645	42	46	40	23	29
GLV 1 1/2-1-1 1/4 "	FG130R0645					
BLK 1 1/2-1-1 1/2 "	FS130R0646	42	46		23	29
GLV 1 1/2-1-1 1/2 "	FG130R0646					
BLK 1 1/2-1 1/4-1 1/4 "	FS130R0655	46	48	45	27	29
GLV 1 1/2-1 1/4-1 1/4 "	FG130R0655					
BLK 1 1/2-1 1/4-1 1/2 "	FS130R0656	46	48		27	29
GLV 1 1/2-1 1/4-1 1/2 "	FG130R0656					
BLK 1 1/2-3/4-1 1/4 "	FS130R0635	38	44	36	17	29
GLV 1 1/2-3/4-1 1/4 "	FG130R0635					
BLK 2-1/2-2 "	FS130R0727	38	48		14	35
GLV 2-1/2-2 "	FG130R0727					
BLK 2-3/4-2 "	FS130R0737	40	50		16	35
GLV 2-3/4-2 "	FG130R0737					

130R

ISO/EN (B1)

Tee
T-Stück
Té
Ti

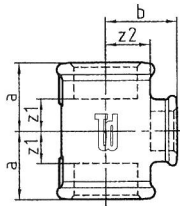
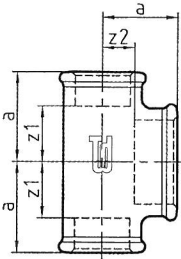
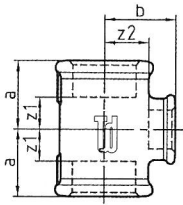

BLK	2-1-1 1/2 "	FS130R0746	44	52	42	20	35
GLV	2-1-1 1/2 "	FG130R0746					
BLK	2-1-2 "	FS130R0747	44	52		20	35
GLV	2-1-2 "	FG130R0747					
BLK	2-1 1/4-1 1/2 "	FS130R0756	48	54	46	24	35
GLV	2-1 1/4-1 1/2 "	FG130R0756					
BLK	2-1 1/4-2 "	FS130R0757	48	54		24	35
GLV	2-1 1/4-2 "	FG130R0757					
BLK	2-1 1/2-2 "	FS130R0767	52	55		28	36
GLV	2-1 1/2-2 "	FG130R0767					
BLK	2-2-1 "	FS130R0774	58	58	52	34	34
GLV	2-2-1 "	FG130R0774					
BLK	2 1/2-2-2 1/2 "	FS130R0878	61	66		34	42
GLV	2 1/2-2-2 1/2 "	FG130R0878					
BLK	3-2-3 "	FG130R0979	64	73		34	49
GLV	3-2-3 "	FG130R0979					

Dimension	Code	Index	Bag	Carton	Gr
BLK 1/2 "	FS01310002	7,25	10	150	170
GLV 1/2 "	FG01310002	9,30	10	150	175
BLK 3/4 "	FS01310003	9,20	10	70	255
GLV 3/4 "	FG01310003	11,75	10	70	265
BLK 1 "	FS01310004	13,90	10	50	525
GLV 1 "	FG01310004	17,80	10	50	540
BLK 2 "	FS01310007	39,65		10	1.840
GLV 2 "	FG01310007	50,90		10	1.900



131

ISO/EN(E1)

Tee
T-Stück
Té
Ti

Dimension	Code	a	c	z	z3	
BLK 1/2 "	FS01310002		45	24	32	11
GLV 1/2 "	FG01310002					
BLK 3/4 "	FS01310003		50	28	35	13
GLV 3/4 "	FG01310003					
BLK 1 "	FS01310004		63	33	46	16
GLV 1 "	FG01310004					
BLK 2 "	FS01310007		102	53	78	29
GLV 2 "	FG01310007					

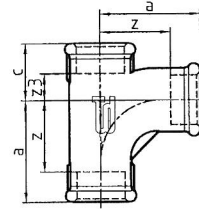

Dimension	Code	Index	Bag	Carton	Gr
BLK 1/2 "	FS01800002	6,55	10	120	150
GLV 1/2 "	FG01800002	8,20	10	120	165
BLK 3/4 "	FS01800003	10,05	10	70	265
GLV 3/4 "	FG01800003	12,30	10	70	280
BLK 1 "	FS01800004	12,30		40	415
GLV 1 "	FG01800004	15,25		40	435
BLK 1 1/4 "	FS01800005	16,35	30	30	605
GLV 1 1/4 "	FG01800005	20,50		30	640
BLK 1 1/2 "	FS01800006	21,65		25	740
GLV 1 1/2 "	FG01800006	27,35		25	780
BLK 2 "	FS01800007	32,25		15	1.390
GLV 2 "	FG01800007	40,85		15	1.440
BLK 2 1/2 "	FS01800008	73,05		6	1.700
GLV 2 1/2 "	FG01800008	92,50		6	1.750



180

ISO/EN(C1)

Cross
Kreuz
Croix
Croce

Dimension	Code	a	b	z	z1
BLK 1/2 "	FS01800002			28	15
GLV 1/2 "	FG01800002				
BLK 3/4 "	FS01800003			33	18
GLV 3/4 "	FG01800003				
BLK 1 "	FS01800004			38	21
GLV 1 "	FG01800004				
BLK 1 1/4 "	FS01800005			45	26
GLV 1 1/4 "	FG01800005				
BLK 1 1/2 "	FS01800006			50	31
GLV 1 1/2 "	FG01800006				
BLK 2 "	FS01800007			58	34
GLV 2 "	FG01800007				
BLK 2 1/2 "	FS01800008			69	42
GLV 2 1/2 "	FG01800008				

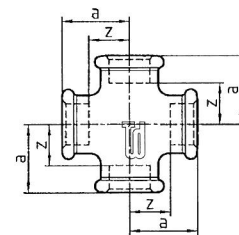

180R
ISO/EN(C1)

Cross

Kreuz

Croix

Croce

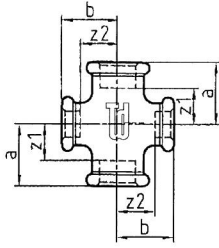

Dimension	Code	Index	Bag	Carton	Gr
BLK 3/4-1/2-3/4-1/2 "	FS180R3232	9,20		80	200
GLV 3/4-1/2-3/4-1/2 "	FG180R3232	11,50		80	205
BLK 1-1/2-1-1/2 "	FS180R4242	18,35		60	275
GLV 1-1/2-1-1/2 "	FG180R4242	23,15		60	285
BLK 1-3/4-1-3/4 "	FS180R4343	18,35		60	325
GLV 1-3/4-1-3/4 "	FG180R4343	23,15		60	340
BLK 1 1/4-1-1 1/4-1 "	FS180R5454	20,15		30	480
GLV 1 1/4-1-1 1/4-1 "	FG180R5454	25,45		30	515
BLK 1 1/2-1-1 1/2-1 "	FS180R6464	28,00		25	575
GLV 1 1/2-1-1 1/2-1 "	FG180R6464	35,50		25	620

Dimension	Code	a	b	z	z1	z2
BLK 3/4-1/2-3/4-1/2 "	30	31		15	18	
GLV 3/4-1/2-3/4-1/2 "						
BLK 1-1/2-1-1/2 "	32	34		15	21	
GLV 1-1/2-1-1/2 "						
BLK 1-3/4-1-3/4 "	35	36		18	21	
GLV 1-3/4-1-3/4 "						
BLK 1 1/4-1-1 1/4-1 "	40	42		21	25	
GLV 1 1/4-1-1 1/4-1 "						
BLK 1 1/2-1-1 1/2-1 "	42	46		23	29	
GLV 1 1/2-1-1 1/2-1 "						

240

ISO/EN (M2)

Socket

Muffe

Manchon

Manicotto

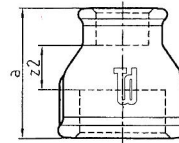

Dimension	Code	Index	Bag	Carton	Gr
BLK 3/4-3/8 "	FS02400031	3,20		250	90
GLV 3/4-3/8 "	FG02400031	4,10		250	95
BLK 3/4-1/2 "	FS02400032	2,70	10	250	90
GLV 3/4-1/2 "	FG02400032	3,45	10	250	95
BLK 1-1/2 "	FS02400042	3,45	10	150	160
GLV 1-1/2 "	FG02400042	4,35	10	150	165
BLK 1-3/4 "	FS02400043	3,10	10	140	175
GLV 1-3/4 "	FG02400043	4,00	10	140	180
BLK 1 1/4-3/4 "	FS02400053	5,80		100	240
GLV 1 1/4-3/4 "	FG02400053	7,35		100	250
BLK 1 1/4-1 "	FS02400054	5,70	10	100	230
GLV 1 1/4-1 "	FG02400054	7,15	10	100	250
BLK 1 1/2-1/2 "	FS02400062	10,30		70	355
GLV 1 1/2-1/2 "	FG02400062	12,95		70	375
BLK 1 1/2-3/4 "	FS02400063	9,00		70	325
GLV 1 1/2-3/4 "	FG02400063	11,40		70	345
BLK 1 1/2-1 "	FS02400064	6,95		70	310
GLV 1 1/2-1 "	FG02400064	8,70		70	320
BLK 1 1/2-1 1/4 "	FS02400065	7,55		70	285
GLV 1 1/2-1 1/4 "	FG02400065	9,55		70	295
BLK 2-1/2 "	FS02400072	14,25		50	540
GLV 2-1/2 "	FG02400072	17,95		50	566
BLK 2-3/4 "	FS02400073	14,85		45	524
GLV 2-3/4 "	FG02400073	18,60		45	547
BLK 2-1 "	FS02400074	13,40		40	515
GLV 2-1 "	FG02400074	17,10		40	530
BLK 2-1 1/4 "	FS02400075	12,05		40	460
GLV 2-1 1/4 "	FG02400075	15,10		40	480
BLK 2-1 1/2 "	FS02400076	11,35		40	450
GLV 2-1 1/2 "	FG02400076	14,30		40	475
BLK 3-2 "	FS02400097	48,40		20	1.226
GLV 3-2 "	FG02400097	61,15		20	1.231
BLK 4-2 "	FS02400007	83,60		10	1.405
GLV 4-2 "	FG02400007	105,85		10	1.445
BLK 4-3 "	FS02400009	89,60		10	1.580
GLV 4-3 "	FG02400009	113,50		10	1.625

Dimension	Code	a	z2
BLK 3/4-3/8 "	FS02400031	39	14
GLV 3/4-3/8 "	FG02400031		
BLK 3/4-1/2 "	FS02400032	39	11
GLV 3/4-1/2 "	FG02400032		
BLK 1-1/2 "	FS02400042	45	15
GLV 1-1/2 "	FG02400042		
BLK 1-3/4 "	FS02400043	45	13
GLV 1-3/4 "	FG02400043		
BLK 1 1/4-3/4 "	FS02400053	50	16
GLV 1 1/4-3/4 "	FG02400053		
BLK 1 1/4-1 "	FS02400054	50	14
GLV 1 1/4-1 "	FG02400054		
BLK 1 1/2-1/2 "	FS02400062	55	23
GLV 1 1/2-1/2 "	FG02400062		
BLK 1 1/2-3/4 "	FS02400063	55	21
GLV 1 1/2-3/4 "	FG02400063		
BLK 1 1/2-1 "	FS02400064	55	19
GLV 1 1/2-1 "	FG02400064		
BLK 1 1/2-1 1/4 "	FS02400065	55	17
GLV 1 1/2-1 1/4 "	FG02400065		
BLK 2-1/2 "	FS02400072	65	28
GLV 2-1/2 "	FG02400072		
BLK 2-3/4 "	FS02400073	65	26
GLV 2-3/4 "	FG02400073		
BLK 2-1 "	FS02400074	65	24
GLV 2-1 "	FG02400074		
BLK 2-1 1/4 "	FS02400075	65	22
GLV 2-1 1/4 "	FG02400075		
BLK 2-1 1/2 "	FS02400076	65	22
GLV 2-1 1/2 "	FG02400076		
BLK 3-2 "	FS02400097	80	26
GLV 3-2 "	FG02400097		
BLK 4-2 "	FS02400007	94	34
GLV 4-2 "	FG02400007		
BLK 4-3 "	FS02400009	94	28
GLV 4-3 "	FG02400009		

241

ISO/EN (N4)

Reducing bush

Reduziernippel

Mamelon Réduit

Nipplo di riduzione

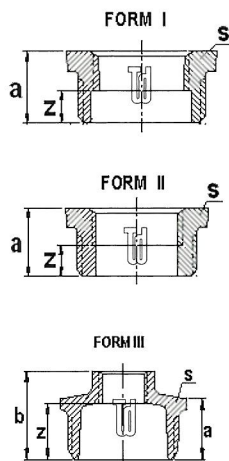

Dimension	Code	Index	Bag	Carton	Gr
BLK 1/2-3/8 "	FS02410021	1,30	10	600	35
GLV 1/2-3/8 "	FG02410021	1,75	10	600	35
BLK 3/4-3/8 "	FS02410031	2,00	10	450	65
GLV 3/4-3/8 "	FG02410031	2,40	10	450	65
BLK 3/4-1/2 "	FS02410032	1,40	10	450	50
GLV 3/4-1/2 "	FG02410032	1,90	10	450	55
BLK 1-3/8 "	FS02410041	3,20	10	250	125
GLV 1-3/8 "	FG02410041	4,00	10	250	130
BLK 1-1/2 "	FS02410042	2,05	10	250	115
GLV 1-1/2 "	FG02410042	2,65	10	250	120
BLK 1-3/4 "	FS02410043	1,90	10	250	100
GLV 1-3/4 "	FG02410043	2,45	10	250	105
BLK 1 1/4-1/2 "	FS02410052	3,75	10	140	165
GLV 1 1/4-1/2 "	FG02410052	4,45	10	140	175
BLK 1 1/4-3/4 "	FS02410053	3,15	10	150	165
GLV 1 1/4-3/4 "	FG02410053	4,00	10	150	175
BLK 1 1/4-1 "	FS02410054	2,40	10	150	130
GLV 1 1/4-1 "	FG02410054	2,95	10	150	135
BLK 1 1/2-1/2 "	FS02410062	4,60	10	120	225
GLV 1 1/2-1/2 "	FG02410062	5,90	10	120	235
BLK 1 1/2-3/4 "	FS02410063	5,25	10	120	230
GLV 1 1/2-3/4 "	FG02410063	6,50	10	120	235
BLK 1 1/2-1 "	FS02410064	3,45	10	140	190
GLV 1 1/2-1 "	FG02410064	4,35	10	140	195
BLK 1 1/2-1 1/4 "	FS02410065	3,55	10	150	125
GLV 1 1/2-1 1/4 "	FG02410065	4,45	10	150	130
BLK 2-1/2 "	FS02410072	9,40		65	365
GLV 2-1/2 "	FG02410072	11,90		65	375
BLK 2-3/4 "	FS02410073	9,30		65	375
GLV 2-3/4 "	FG02410073	11,75		65	385
BLK 2-1 "	FS02410074	7,65		60	390
GLV 2-1 "	FG02410074	9,65		60	400
BLK 2-1 1/4 "	FS02410075	7,25		60	330
GLV 2-1 1/4 "	FG02410075	9,15		60	340
BLK 2-1 1/2 "	FS02410076	6,50		75	275
GLV 2-1 1/2 "	FG02410076	8,25		75	280
BLK 2 1/2-1 "	FS02410084	15,20		30	690
GLV 2 1/2-1 "	FG02410084	19,00		30	700
BLK 2 1/2-1 1/4 "	FS02410085	17,45		30	710
GLV 2 1/2-1 1/4 "	FG02410085	21,95		30	720
BLK 2 1/2-1 1/2 "	FS02410086	16,65		35	625
GLV 2 1/2-1 1/2 "	FG02410086	20,75		35	645
BLK 2 1/2-2 "	FS02410087	12,55		35	505
GLV 2 1/2-2 "	FG02410087	15,85		35	520
BLK 3-1 "	FS02410094	23,55		30	800
GLV 3-1 "	FG02410094	29,75		30	830
BLK 3-1 1/4 "	FS02410095	23,55		30	900
GLV 3-1 1/4 "	FG02410095	29,75		30	920
BLK 3-1 1/2 "	FS02410096	22,00		30	880
GLV 3-1 1/2 "	FG02410096	27,60		30	905
BLK 3-2 "	FS02410097	16,45		30	940
GLV 3-2 "	FG02410097	20,45		30	955
BLK 3-2 1/2 "	FS02410098	18,60		30	660
GLV 3-2 1/2 "	FG02410098	23,15		30	665
BLK 4-2 "	FS02410007	47,10		16	1.520
GLV 4-2 "	FG02410007	59,65		16	1.535
BLK 4-2 1/2 "	FS02410008	35,00		16	1.490
GLV 4-2 1/2 "	FG02410008	44,35		16	1.535
BLK 4-3 "	FS02410009	33,55		16	1.390
GLV 4-3 "	FG02410009	42,55		16	1.430

241

ISO/EN(N4)

Reducing bush

Reduziernippel

Mamelon Réduit

Niplo di riduzione



Dimension	Code	a	b	s	z
BLK 1/2-3/8 "	FS0241002124		22	14	
GLV 1/2-3/8 "	FG02410021				
BLK 3/4-3/8 "	FS0241003126		36	17	
GLV 3/4-3/8 "	FG02410031				
BLK 3/4-1/2 "	FS0241003226		30	13	
GLV 3/4-1/2 "	FG02410032				
BLK 1-3/8 "	FS0241004129		38	19	
GLV 1-3/8 "	FG02410041				
BLK 1-1/2 "	FS0241004229		38	16	
GLV 1-1/2 "	FG02410042				
BLK 1-3/4 "	FS0241004329		38	14	
GLV 1-3/4 "	FG02410043				
BLK 1 1/4-1/2 "	FS0241005231		46	18	
GLV 1 1/4-1/2 "	FG02410052				
BLK 1 1/4-3/4 "	FS0241005331		46	16	
GLV 1 1/4-3/4 "	FG02410053				
BLK 1 1/4-1 "	FS0241005431		46	16	
GLV 1 1/4-1 "	FG02410054				
BLK 1 1/2-1/2 "	FS0241006231		50	18	
GLV 1 1/2-1/2 "	FG02410062				
BLK 1 1/2-3/4 "	FS0241006331		50	16	
GLV 1 1/2-3/4 "	FG02410063				
BLK 1 1/2-1 "	FS0241006431		50	14	
GLV 1 1/2-1 "	FG02410064				
BLK 1 1/2-1 1/4 "	FS0241006531		50	12	
GLV 1 1/2-1 1/4 "	FG02410065				
BLK 2-1/2 "	FS0241007235	48	65	35	
GLV 2-1/2 "	FG02410072				
BLK 2-3/4 "	FS0241007335	48	65	33	
GLV 2-3/4 "	FG02410073				
BLK 2-1 "	FS0241007435		65	20	
GLV 2-1 "	FG02410074				
BLK 2-1 1/4 "	FS0241007535		65	18	
GLV 2-1 1/4 "	FG02410075				
BLK 2-1 1/2 "	FS0241007635		64	18	
GLV 2-1 1/2 "	FG02410076				
BLK 2 1/2-1 "	FS0241008440	54	80	37	
GLV 2 1/2-1 "	FG02410084				
BLK 2 1/2-1 1/4 "	FS0241008540	54	80	35	
GLV 2 1/2-1 1/4 "	FG02410085				
BLK 2 1/2-1 1/2 "	FS0241008640		80	21	
GLV 2 1/2-1 1/2 "	FG02410086				
BLK 2 1/2-2 "	FS0241008740		80	16	
GLV 2 1/2-2 "	FG02410087				
BLK 3-1 "	FS0241009444	59	96	42	
GLV 3-1 "	FG02410094				
BLK 3-1 1/4 "	FS0241009544	59	97	40	
GLV 3-1 1/4 "	FG02410095				
BLK 3-1 1/2 "	FS0241009644	59	97	40	
GLV 3-1 1/2 "	FG02410096				
BLK 3-2 "	FS0241009744		97	20	
GLV 3-2 "	FG02410097				
BLK 3-2 1/2 "	FS0241009844		97	17	
GLV 3-2 1/2 "	FG02410098				
BLK 4-2 "	FS0241000751	69	122	46	
GLV 4-2 "	FG02410007				
BLK 4-2 1/2 "	FS0241000851	69	122	42	
GLV 4-2 1/2 "	FG02410008				
BLK 4-3 "	FS0241000951		122	21	
GLV 4-3 "	FG02410009				

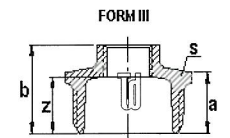
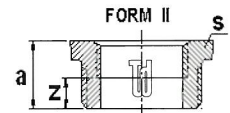
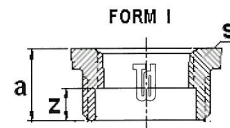



245

ISO/EN (N8)

Hexagon nipple

Doppelnippel

Mamelon

Nipplo doppio

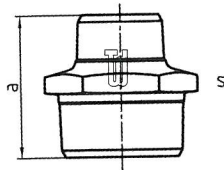

Dimension	Code	Index	Bag	Carton	Gr
BLK 1/2-3/8 "	FS02450021	3.20	10	450	55
GLV 1/2-3/8 "	FG02450021	4.10	10	450	60
BLK 3/4-1/2 "	FS02450032	2.90	10	250	100
GLV 3/4-1/2 "	FG02450032	3.60	10	250	105
BLK 1-1/2 "	FS02450042	5.70	10	150	165
GLV 1-1/2 "	FG02450042	7.20	10	150	170
BLK 1-3/4 "	FS02450043	3.20	10	150	165
GLV 1-3/4 "	FG02450043	4.10	10	150	175
BLK 1 1/4-1/2 "	FS02450052	8.80		100	265
GLV 1 1/4-1/2 "	FG02450052	11.10		100	280
BLK 1 1/4-3/4 "	FS02450053	7.65		100	225
GLV 1 1/4-3/4 "	FG02450053	9.45		100	240
BLK 1 1/4-1 "	FS02450054	5.30	10	100	245
GLV 1 1/4-1 "	FG02450054	6.55	10	100	260
BLK 1 1/2-3/4 "	FS02450063	7.65		90	375
GLV 1 1/2-3/4 "	FG02450063	9.55		90	390
BLK 1 1/2-1 "	FS02450064	12.05	10	90	265
GLV 1 1/2-1 "	FG02450064	15.25	10	90	275
BLK 1 1/2-1 1/4 "	FS02450065	6.45		90	290
GLV 1 1/2-1 1/4 "	FG02450065	8.20		90	305
BLK 2-1 "	FS02450074	10.90		45	525
GLV 2-1 "	FG02450074	13.75		45	545
BLK 2-1 1/4 "	FS02450075	13.70		45	540
GLV 2-1 1/4 "	FG02450075	17.10		45	550
BLK 2-1 1/2 "	FS02450076	12.35		45	540
GLV 2-1 1/2 "	FG02450076	15.60		45	560
BLK 2 1/2-2 "	FS02450087	30.15		20	690
GLV 2 1/2-2 "	FG02450087	37.55		20	720
BLK 3-2 "	FS02450097	36.60		15	1.296
GLV 3-2 "	FG02450097	46.25		15	1.314
BLK 3-2 1/2 "	FS02450098	48.00		15	1.390
GLV 3-2 1/2 "	FG02450098	60.75		15	1.405
BLK 4-3 "	FS02450009	90.05		10	2.060
GLV 4-3 "	FG02450009	114.10		10	2.075

Dimension	Code	a	s
BLK 1/2-3/8 "	FS02450021	44	22
GLV 1/2-3/8 "	FG02450021		
BLK 3/4-1/2 "	FS02450032	47	30
GLV 3/4-1/2 "	FG02450032		
BLK 1-1/2 "	FS02450042	53	36
GLV 1-1/2 "	FG02450042		
BLK 1-3/4 "	FS02450043	53	36
GLV 1-3/4 "	FG02450043		
BLK 1 1/4-1/2 "	FS02450052	57	50
GLV 1 1/4-1/2 "	FG02450052		
BLK 1 1/4-3/4 "	FS02450053	57	46
GLV 1 1/4-3/4 "	FG02450053		
BLK 1 1/4-1 "	FS02450054	57	46
GLV 1 1/4-1 "	FG02450054		
BLK 1 1/2-3/4 "	FS02450063	59	60
GLV 1 1/2-3/4 "	FG02450063		
BLK 1 1/2-1 "	FS02450064	59	50
GLV 1 1/2-1 "	FG02450064		
BLK 1 1/2-1 1/4 "	FS02450065	59	50
GLV 1 1/2-1 1/4 "	FG02450065		
BLK 2-1 "	FS02450074	68	65
GLV 2-1 "	FG02450074		
BLK 2-1 1/4 "	FS02450075	68	65
GLV 2-1 1/4 "	FG02450075		
BLK 2-1 1/2 "	FS02450076	68	65
GLV 2-1 1/2 "	FG02450076		
BLK 2 1/2-2 "	FS02450087	75	90
GLV 2 1/2-2 "	FG02450087		
BLK 3-2 "	FS02450097	83	100
GLV 3-2 "	FG02450097		
BLK 3-2 1/2 "	FS02450098	83	100
GLV 3-2 1/2 "	FG02450098		
BLK 4-3 "	FS02450009	94	130
GLV 4-3 "	FG02450009		

246

ISO/DIN (M4)

Reducing sockets
male/female

Reduziermuffen mit
Innen-und Außen-
gewinde

Manchons réduits
mâles/femelles

Manicotti ridotti
maschio/femmina

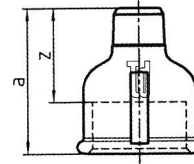

Dimension	Code	Index	Bag	Carton	Gr
BLK 1/2-3/8 "	FS02460021	2,65	10	300	75
GLV 1/2-3/8 "	FG02460021	3,30	10	300	80
BLK 3/4-1/2 "	FS02460032	2,80	10	180	110
GLV 3/4-1/2 "	FG02460032	3,55	10	180	115
BLK 1-1/2 "	FS02460042	4,35	10	100	165
GLV 1-1/2 "	FG02460042	5,45	10	100	175
BLK 1 1/2-1 "	FS02460064	9,90		60	335
GLV 1 1/2-1 "	FG02460064	12,30		60	350

Dimension	Code	a	z
BLK 1/2-3/8 "	FS02460021	43	30
GLV 1/2-3/8 "	FG02460021		
BLK 3/4-1/2 "	FS02460032	48	33
GLV 3/4-1/2 "	FG02460032		
BLK 1-1/2 "	FS02460042	55	38
GLV 1-1/2 "	FG02460042		
BLK 1 1/2-1 "	FS02460064	63	44
GLV 1 1/2-1 "	FG02460064		

Dimension	Code	Index	Bag	Carton	Gr
BLK 3/8 "	FS02700001	2,00	10	500	55
GLV 3/8 "	FG02700001	2,40	10	500	60
BLK 1/2 "	FS02700002	1,55	10	370	70
GLV 1/2 "	FG02700002	1,95	10	370	75
BLK 3/4 "	FS02700003	2,05	10	200	105
GLV 3/4 "	FG02700003	2,65	10	200	110
BLK 1 "	FS02700004	2,70	10	140	160
GLV 1 "	FG02700004	3,50	10	140	170
BLK 1 1/4 "	FS02700005	4,40		100	240
GLV 1 1/4 "	FG02700005	5,55		100	250
BLK 1 1/2 "	FS02700006	6,20		70	305
GLV 1 1/2 "	FG02700006	8,00		70	315
BLK 2 "	FS02700007	9,40		35	420
GLV 2 "	FG02700007	11,90		35	445
BLK 2 1/2 "	FS02700008	26,45		24	750
GLV 2 1/2 "	FG02700008	32,85		24	775
BLK 3 "	FS02700009	31,70		15	1.030
GLV 3 "	FG02700009	39,45		15	1.095
BLK 4 "	FS02700000	72,85		7	2.360
GLV 4 "	FG02700000	92,10		7	2.420

270

ISO/EN (M2)

Socket

Muffe

Manchon

Manicotto

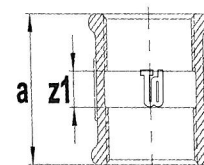

Dimension	Code	a	z1
BLK 3/8 "	FS02700001	30	10
GLV 3/8 "	FG02700001		
BLK 1/2 "	FS02700002	36	10
GLV 1/2 "	FG02700002		
BLK 3/4 "	FS02700003	39	9
GLV 3/4 "	FG02700003		
BLK 1 "	FS02700004	45	11
GLV 1 "	FG02700004		
BLK 1 1/4 "	FS02700005	50	12
GLV 1 1/4 "	FG02700005		
BLK 1 1/2 "	FS02700006	55	17
GLV 1 1/2 "	FG02700006		
BLK 2 "	FS02700007	65	17
GLV 2 "	FG02700007		
BLK 2 1/2 "	FS02700008	74	20
GLV 2 1/2 "	FG02700008		
BLK 3 "	FS02700009	80	20
GLV 3 "	FG02700009		
BLK 4 "	FS02700000	94	22
GLV 4 "	FG02700000		



271

ISO/EN (M2 R-L)

Socket, right and left hand thread

Muffe mit Rechts- und Linksgewinde

Manchon filetage droite/gauche

Manicotto con filettatura destra/sinistra

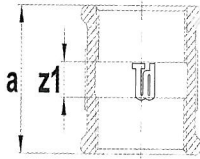

Dimension	Code	Index	Bag	Carton	Gr
BLK 3/8 "	FS02710001	2,70	10	500	55
GLV 3/8 "	FG02710001	3,40	10	500	60
BLK 1/2 "	FS02710002	2,45	10	370	70
GLV 1/2 "	FG02710002	3,05	10	370	75
BLK 3/4 "	FS02710003	3,15	10	200	105
GLV 3/4 "	FG02710003	4,05	10	200	110
BLK 1 "	FS02710004	4,20	10	140	150
GLV 1 "	FG02710004	5,30	10	140	160
BLK 1 1/4 "	FS02710005	8,05		100	240
GLV 1 1/4 "	FG02710005	10,15		100	250
BLK 1 1/2 "	FS02710006	8,80		70	240
GLV 1 1/2 "	FG02710006	11,10		70	310
BLK 2 "	FS02710007	15,80		35	420
GLV 2 "	FG02710007	19,90		35	455

Dimension	Code	a	z1
BLK 3/8 "	FS02710001	30	10
GLV 3/8 "	FG02710001		
BLK 1/2 "	FS02710002	36	10
GLV 1/2 "	FG02710002		
BLK 3/4 "	FS02710003	39	9
GLV 3/4 "	FG02710003		
BLK 1 "	FS02710004	45	11
GLV 1 "	FG02710004		
BLK 1 1/4 "	FS02710005	50	12
GLV 1 1/4 "	FG02710005		
BLK 1 1/2 "	FS02710006	55	17
GLV 1 1/2 "	FG02710006		
BLK 2 "	FS02710007	65	17
GLV 2 "	FG02710007		

Dimension	Code	Index	Bag	Carton	Gr
BLK 3/8 "	FS02800001	2,65	10	500	45
GLV 3/8 "	FG02800001	3,30	10	500	45
BLK 1/2 "	FS02800002	1,40	10	400	60
GLV 1/2 "	FG02800002	1,80	10	400	65
BLK 3/4 "	FS02800003	1,90	10	260	100
GLV 3/4 "	FG02800003	2,40	10	260	105
BLK 1 "	FS02800004	2,60	10	150	160
GLV 1 "	FG02800004	3,40	10	150	170
BLK 1 1/4 "	FS02800005	4,40	10	90	285
GLV 1 1/4 "	FG02800005	5,55	10	90	295
BLK 1 1/2 "	FS02800006	5,20	70	70	385
GLV 1 1/2 "	FG02800006	6,40	70	70	405
BLK 2 "	FS02800007	9,20	40	40	525
GLV 2 "	FG02800007	11,55	40	40	550
BLK 2 1/2 "	FS02800008	16,65	20	20	860
GLV 2 1/2 "	FG02800008	20,75	20	20	880
BLK 3 "	FS02800009	20,15	15	15	1.215
GLV 3 "	FG02800009	25,00	15	15	1.235
BLK 4 "	FS02800000	72,85	9	9	1.695
GLV 4 "	FG02800000	92,10	9	9	1.765

280

ISO/EN (N8)

Hexagon nipple

Doppelnippel

Mamelon

Nipplo doppio



Dimension	Code	a	s
BLK 3/8 "	FS02800001	38	22
GLV 3/8 "	FG02800001		
BLK 1/2 "	FS02800002	44	27
GLV 1/2 "	FG02800002		
BLK 3/4 "	FS02800003	47	34
GLV 3/4 "	FG02800003		
BLK 1 "	FS02800004	53	41
GLV 1 "	FG02800004		
BLK 1 1/4 "	FS02800005	57	50
GLV 1 1/4 "	FG02800005		
BLK 1 1/2 "	FS02800006	59	54
GLV 1 1/2 "	FG02800006		
BLK 2 "	FS02800007	68	69
GLV 2 "	FG02800007		
BLK 2 1/2 "	FS02800008	75	85
GLV 2 1/2 "	FG02800008		
BLK 3 "	FS02800009	83	99
GLV 3 "	FG02800009		
BLK 4 "	FS02800000	95	131
GLV 4 "	FG02800000		

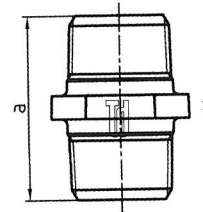

290

ISO/EN (T9)

Plug, beaded

Stopfen mit
Rand

Bouchon avec
collet

Tappo con
bordo

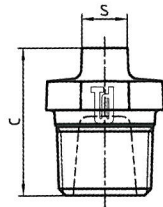

Dimension	Code	Index	Bag	Carton	Gr
BLK 3/8 "	FS02900001	1,15	10	500	30
GLV 3/8 "	FG02900001	1,40	10	500	30
BLK 1/2 "	FS02900002	1,15	10	600	45
GLV 1/2 "	FG02900002	1,40	10	600	50
BLK 3/4 "	FS02900003	1,55	10	400	70
GLV 3/4 "	FG02900003	1,90	10	400	75
BLK 1 "	FS02900004	1,75	10	240	115
GLV 1 "	FG02900004	2,10	10	240	120
BLK 1 1/4 "	FS02900005	3,05	10	150	175
GLV 1 1/4 "	FG02900005	3,85	10	150	180
BLK 1 1/2 "	FS02900006	3,85	10	110	230
GLV 1 1/2 "	FG02900006	4,70	10	110	240
BLK 2 "	FS02900007	6,85		70	380
GLV 2 "	FG02900007	8,45		70	390
BLK 2 1/2 "	FS02900008	14,50		30	700
GLV 2 1/2 "	FG02900008	18,35		30	705
BLK 3 "	FS02900009	18,80		25	1.130
GLV 3 "	FG02900009	23,70		25	1.145
BLK 4 "	FS02900000	33,05		15	1.355
GLV 4 "	FG02900000	41,85		15	1.385

Dimension	Code	c	s
BLK 3/8 "	FS02900001	24	10
GLV 3/8 "	FG02900001		
BLK 1/2 "	FS02900002	27	11
GLV 1/2 "	FG02900002		
BLK 3/4 "	FS02900003	32	17
GLV 3/4 "	FG02900003		
BLK 1 "	FS02900004	37	18
GLV 1 "	FG02900004		
BLK 1 1/4 "	FS02900005	40	22
GLV 1 1/4 "	FG02900005		
BLK 1 1/2 "	FS02900006	41	22
GLV 1 1/2 "	FG02900006		
BLK 2 "	FS02900007	48	27
GLV 2 "	FG02900007		
BLK 2 1/2 "	FS02900008	54	32
GLV 2 1/2 "	FG02900008		
BLK 3 "	FS02900009	60	37
GLV 3 "	FG02900009		
BLK 4 "	FS02900000	73	41
GLV 4 "	FG02900000		

Dimension	Code	Index	Bag	Carton	Gr
BLK 1/2 "	FS02910002	1,20	10	800	30
GLV 1/2 "	FG02910002	1,60	10	800	30
BLK 3/4 "	FS02910003	1,80	10	500	55
GLV 3/4 "	FG02910003	2,40	10	500	55
BLK 1 "	FS02910004	2,25	10	280	95
GLV 1 "	FG02910004	2,80	10	280	100
BLK 1 1/4 "	FS02910005	3,10	10	200	125
GLV 1 1/4 "	FG02910005	4,00	10	200	130
BLK 1 1/2 "	FS02910006	5,35	10	170	150
GLV 1 1/2 "	FG02910006	6,65	10	170	155
BLK 2 "	FS02910007	7,35		85	305
GLV 2 "	FG02910007	9,15		85	320
BLK 3 "	FS02910009	17,10		40	675
GLV 3 "	FG02910009	21,50		40	685
BLK 4 "	FS02910000	59,35		20	1.295
GLV 4 "	FG02910000	75,15		20	1.310

291

ISO/EN (T8)

Plug, plain

Stopfen ohne
Rand

Bouchon sans
collet

Tappo senza
bordo



Dimension	Code	b	s
BLK 1/2 "	FS02910002	23	11
GLV 1/2 "	FG02910002		
BLK 3/4 "	FS02910003	26	17
GLV 3/4 "	FG02910003		
BLK 1 "	FS02910004	32	19
GLV 1 "	FG02910004		
BLK 1 1/4 "	FS02910005	32	22
GLV 1 1/4 "	FG02910005		
BLK 1 1/2 "	FS02910006	33	22
GLV 1 1/2 "	FG02910006		
BLK 2 "	FS02910007	42	27
GLV 2 "	FG02910007		
BLK 3 "	FS02910009	46	32
GLV 3 "	FG02910009		
BLK 4 "	FS02910000	60	36
GLV 4 "	FG02910000		

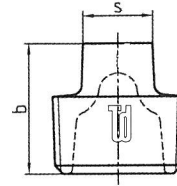

300

ISO/EN(T1)

Cap

Kappe

Bouchon

Calotta

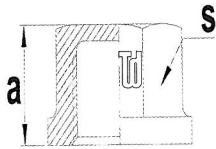

Dimension	Code	Index	Bag	Carton	Gr
BLK 1/2 "	FS03000002	1,75	10	400	60
GLV 1/2 "	FG03000002	2,25	10	400	65
BLK 3/4 "	FS03000003	2,05	10	250	90
GLV 3/4 "	FG03000003	2,65	10	250	95
BLK 1 "	FS03000004	2,50	10	190	145
GLV 1 "	FG03000004	3,10	10	190	155
BLK 1 1/4 "	FS03000005	3,85	10	120	195
GLV 1 1/4 "	FG03000005	4,70	10	120	205
BLK 1 1/2 "	FS03000006	4,75	10	110	260
GLV 1 1/2 "	FG03000006	5,85	10	110	270
BLK 2 "	FS03000007	8,80		70	325
GLV 2 "	FG03000007	11,05		70	340
BLK 2 1/2 "	FS03000008	16,10		30	870
GLV 2 1/2 "	FG03000008	20,10		30	910
BLK 3 "	FS03000009	17,60		25	960
GLV 3 "	FG03000009	22,00		25	1.020
BLK 4 "	FS03000000	37,95		13	1.625
GLV 4 "	FG03000000	48,15		13	1.670

Dimension	Code	a	s
BLK 1/2 "	FS03000002	23	26
GLV 1/2 "	FG03000002		
BLK 3/4 "	FS03000003	26	32
GLV 3/4 "	FG03000003		
BLK 1 "	FS03000004	30	38
GLV 1 "	FG03000004		
BLK 1 1/4 "	FS03000005	33	46
GLV 1 1/4 "	FG03000005		
BLK 1 1/2 "	FS03000006	36	52
GLV 1 1/2 "	FG03000006		
BLK 2 "	FS03000007	40	62
GLV 2 "	FG03000007		
BLK 2 1/2 "	FS03000008	43	85
GLV 2 1/2 "	FG03000008		
BLK 3 "	FS03000009	45	97
GLV 3 "	FG03000009		
BLK 4 "	FS03000000	47	123
GLV 4 "	FG03000000		

Dimension	Code	Index	Bag	Carton	Gr
BLK 1/2 "	FS03100002	1,30	10	900	35
GLV 1/2 "	FG03100002	1,65	10	900	40
BLK 3/4 "	FS03100003	1,40	10	540	45
GLV 3/4 "	FG03100003	1,75	10	540	50
BLK 1 "	FS03100004	2,10	10	300	80
GLV 1 "	FG03100004	2,55	10	300	85
BLK 1 1/4 "	FS03100005	3,05		235	105
GLV 1 1/4 "	FG03100005	3,75		235	110
BLK 1 1/2 "	FS03100006	3,40		200	130
GLV 1 1/2 "	FG03100006	4,20		200	135
BLK 2 "	FS03100007	6,75		110	210
GLV 2 "	FG03100007	8,40		110	220
BLK 2 1/2 "	FS03100008	15,00		80	340
GLV 2 1/2 "	FG03100008	18,90		80	348

310
ISO/EN(P4)
 Backnut
 Gegenmutter
 Contre-écrou
 Controdado



Dimension	Code	a	s
BLK 1/2 "	FS03100002	9	32
GLV 1/2 "	FG03100002		
BLK 3/4 "	FS03100003	10	36
GLV 3/4 "	FG03100003		
BLK 1 "	FS03100004	11	46
GLV 1 "	FG03100004		
BLK 1 1/4 "	FS03100005	12	55
GLV 1 1/4 "	FG03100005		
BLK 1 1/2 "	FS03100006	13	60
GLV 1 1/2 "	FG03100006		
BLK 2 "	FS03100007	14	75
GLV 2 "	FG03100007		
BLK 2 1/2 "	FS03100008	16	95
GLV 2 1/2 "	FG03100008		

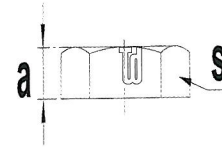

330

ISO/EN(U1)

Union,
flat seat

Verschraubung,
flach dichtend

Manchon union
à joint plat

Bocchettone a
sede piana

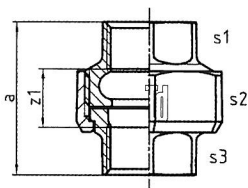

Dimension	Code	Index	Bag	Carton	Gr
BLK 1/2 "	FS03300002	5,85	10	130	210
GLV 1/2 "	FG03300002	7,05	10	130	215
BLK 3/4 "	FS03300003	6,65	10	80	300
GLV 3/4 "	FG03300003	8,25	10	80	310
BLK 1 "	FS03300004	7,40	10	70	335
GLV 1 "	FG03300004	9,40	10	70	345
BLK 1 1/4 "	FS03300005	12,85		40	605
GLV 1 1/4 "	FG03300005	16,10		40	620
BLK 1 1/2 "	FS03300006	16,50		35	680
GLV 1 1/2 "	FG03300006	20,85		35	695
BLK 2 "	FS03300007	27,20		20	995
GLV 2 "	FG03300007	34,60		20	1.015
BLK 2 1/2 "	FS03300008	62,75		12	1.805
GLV 2 1/2 "	FG03300008	79,30		12	1.850
BLK 3 "	FS03300009	92,05		10	2.575
GLV 3 "	FG03300009	116,45		10	2.630

Dimension	Code	a	z1	s1	s2	s3
BLK 1/2 "	FS03300002	48	22	26	42	26
GLV 1/2 "	FG03300002					
BLK 3/4 "	FS03300003	52	22	31	50	31
GLV 3/4 "	FG03300003					
BLK 1 "	FS03300004	59	25	38	55	38
GLV 1 "	FG03300004					
BLK 1 1/4 "	FS03300005	65	27	48	68	48
GLV 1 1/4 "	FG03300005					
BLK 1 1/2 "	FS03300006	70	32	54	75	54
GLV 1 1/2 "	FG03300006					
BLK 2 "	FS03300007	80	30	66	90	65
GLV 2 "	FG03300007					
BLK 2 1/2 "	FS03300008	85	31	83	110	83
GLV 2 1/2 "	FG03300008					
BLK 3 "	FS03300009	95	35	96	130	97
GLV 3 "	FG03300009					

331

ISO/EN(U2)

Union, flat seat

Verschraubung,
flach dichtend

Manchon union
à joint plat

Bocchettone a
sede piana

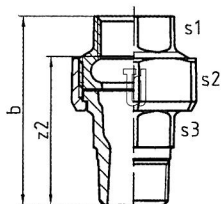

Dimension	Code	Index	Bag	Carton	Gr
BLK 1/2 "	FS03310002	6,70	10	120	225
GLV 1/2 "	FG03310002	8,30	10	120	230
BLK 3/4 "	FS03310003	7,30	10	80	320
GLV 3/4 "	FG03310003	9,30	10	80	325
BLK 1 "	FS03310004	8,90		60	390
GLV 1 "	FG03310004	11,10		60	405
BLK 1 1/4 "	FS03310005	15,40		35	775
GLV 1 1/4 "	FG03310005	20,20		35	805
BLK 1 1/2 "	FS03310006	19,40		30	825
GLV 1 1/2 "	FG03310006	24,45		30	855
BLK 2 "	FS03310007	30,20		15	1.180
GLV 2 "	FG03310007	38,25		15	1.220

Dimension	Code	b	z2	s1	s2	s3
BLK 1/2 "	FS03310002	66	53	26	42	26
GLV 1/2 "	FG03310002					
BLK 3/4 "	FS03310003	72	57	31	50	31
GLV 3/4 "	FG03310003					
BLK 1 "	FS03310004	80	63	38	55	38
GLV 1 "	FG03310004					
BLK 1 1/4 "	FS03310005	90	71	48	68	47
GLV 1 1/4 "	FG03310005					
BLK 1 1/2 "	FS03310006	95	76	54	75	53
GLV 1 1/2 "	FG03310006					
BLK 2 "	FS03310007	106	82	66	90	65
GLV 2 "	FG03310007					

340

ISO/EN (U11)

Union, taper seat



Verschraubung mit Kegeldichtung

Manchon union à joint conique

Bocchettone a sede conica

Dimension	Code	Index	Bag	Carton	Gr
BLK 1/2 "	FS03400002	7,00	10	130	210
GLV 1/2 "	FG03400002	8,80	10	130	215
BLK 3/4 "	FS03400003	7,90	10	80	305
GLV 3/4 "	FG03400003	10,00	10	80	310
BLK 1 "	FS03400004	9,20	10	70	335
GLV 1 "	FG03400004	11,50	10	70	340
BLK 1 1/4 "	FS03400005	15,20		40	620
GLV 1 1/4 "	FG03400005	19,80		40	630
BLK 1 1/2 "	FS03400006	17,90		35	665
GLV 1 1/2 "	FG03400006	23,15		35	675
BLK 2 "	FS03400007	29,35		20	980
GLV 2 "	FG03400007	38,10		20	1.000
BLK 2 1/2 "	FS03400008	66,35		12	1.600
GLV 2 1/2 "	FG03400008	84,00		12	1.650
BLK 3 "	FS03400009	92,55		10	2.335
GLV 3 "	FG03400009	117,15		10	2.410
BLK 4 "	FS03400000	186,80		4	3.210
GLV 4 "	FG03400000	236,70		4	3.300

Dimension	Code	a	z1	s1	s2	s3
BLK 1/2 "	FS03400002	48	22	26	42	26
GLV 1/2 "	FG03400002					
BLK 3/4 "	FS03400003	52	22	31	50	31
GLV 3/4 "	FG03400003					
BLK 1 "	FS03400004	58	24	38	55	38
GLV 1 "	FG03400004					
BLK 1 1/4 "	FS03400005	65	27	48	68	48
GLV 1 1/4 "	FG03400005					
BLK 1 1/2 "	FS03400006	70	32	54	75	54
GLV 1 1/2 "	FG03400006					
BLK 2 "	FS03400007	78	30	65	90	65
GLV 2 "	FG03400007					
BLK 2 1/2 "	FS03400008	85	31	85	110	85
GLV 2 1/2 "	FG03400008					
BLK 3 "	FS03400009	95	35	95	130	95
GLV 3 "	FG03400009					
BLK 4 "	FS03400000	110	38	122	150	122
GLV 4 "	FG03400000					

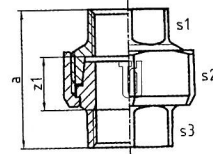



341

ISO/EN (U12)

Union, taper seat

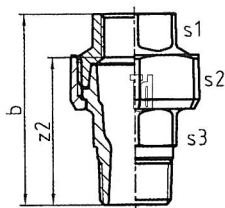
Verschraubung mit
KegeldichtungManchon union à
joint coniqueBocchettone a
sede conica

Dimension	Code	Index	Bag	Carton	Gr
BLK 1/2 "	FS03410002	6,90	10	120	220
GLV 1/2 "	FG03410002	8,60	10	120	230
BLK 3/4 "	FS03410003	8,30	10	80	320
GLV 3/4 "	FG03410003	10,40	10	80	335
BLK 1 "	FS03410004	10,30		60	405
GLV 1 "	FG03410004	12,90		60	430
BLK 1 1/4 "	FS03410005	16,30		35	790
GLV 1 1/4 "	FG03410005	20,50		35	815
BLK 1 1/2 "	FS03410006	20,85		30	815
GLV 1 1/2 "	FG03410006	26,30		30	850
BLK 2 "	FS03410007	33,30		15	1.230
GLV 2 "	FG03410007	42,00		15	1.270
BLK 2 1/2 "	FS03410008	72,50		10	2.256
GLV 2 1/2 "	FG03410008	91,70		10	2.292
BLK 3 "	FS03410009	113,25		5	3.000
GLV 3 "	FG03410009	143,40		5	3.100
BLK 4 "	FS03410000	207,55		4	4.170
GLV 4 "	FG03410000	263,00		4	4.250

Dimension	Code	b	z2	s1	s2	s3
BLK 1/2 "	FS03410002	66	53	26	42	26
GLV 1/2 "	FG03410002					
BLK 3/4 "	FS03410003	72	57	31	50	31
GLV 3/4 "	FG03410003					
BLK 1 "	FS03410004	80	63	38	55	38
GLV 1 "	FG03410004					
BLK 1 1/4 "	FS03410005	90	71	48	68	47
GLV 1 1/4 "	FG03410005					
BLK 1 1/2 "	FS03410006	95	76	54	75	53
GLV 1 1/2 "	FG03410006					
BLK 2 "	FS03410007	106	82	65	90	65
GLV 2 "	FG03410007					
BLK 2 1/2 "	FS03410008	122	95	85	110	85
GLV 2 1/2 "	FG03410008					
BLK 3 "	FS03410009	130	100	95	130	95
GLV 3 "	FG03410009					
BLK 4 "	FS03410000	153	117	122	150	120
GLV 4 "	FG03410000					

Dimension	Gew.374 » G«		Code	Index	Bag	Carton	Gr
BLK	1/2 "	1	FS03700002	2,25		350	85
GLV	1/2 "	1	FG03700002	2,70		350	90
BLK	3/4 "	1	FS03700003	2,80		250	100
GLV	3/4 "	1	FG03700003	3,50		250	110
BLK	1 "	2	FS03700004	3,30		190	135
GLV	1 "	2	FG03700004	4,20		190	140
BLK	1 1/4 "	2	FS03700005	4,75		100	215
GLV	1 1/4 "	2	FG03700005	5,90		100	220
BLK	1 1/2 "	2	FS03700006	6,20		80	280
GLV	1 1/2 "	2	FG03700006	7,55		80	285
BLK	2 "	3	FS03700007	10,95		50	445
GLV	2 "	3	FG03700007	13,60		50	455
BLK	2 1/2 "	4	FS03700008	21,75		30	780
GLV	2 1/2 "	4	FG03700008	27,55		30	810
BLK	3 "	4	FS03700009	31,95		20	885
GLV	3 "	4	FG03700009	40,35		20	1000

370

Union bush

Einschraubteil

Pièce fileté

Pezzo filettato



Dimension	Gew.374 » G«		Code	a	z	s	
BLK	1/2 "	1	FS03700002	25	12	26	6 kant
GLV	1/2 "	1	FG03700002				6 kant
BLK	3/4 "	1	FS03700003	28	13	31	6 kant
GLV	3/4 "	1	FG03700003				6 kant
BLK	1 "	2	FS03700004	31	14	38	6 kant
GLV	1 "	2	FG03700004				6 kant
BLK	1 1/4 "	2	FS03700005	33	14	48	6 kant
GLV	1 1/4 "	2	FG03700005				6 kant
BLK	1 1/2 "	2	FS03700006	36	17	54	6 kant
GLV	1 1/2 "	2	FG03700006				6 kant
BLK	2 "	3	FS03700007	42	18	66	6 kant
GLV	2 "	3	FG03700007				6 kant
BLK	2 1/2 "	4	FS03700008	46	19	84	8 kant
GLV	2 1/2 "	4	FG03700008				8 kant
BLK	3 "	4	FS03700009	52	22	95	8 kant
GLV	3 "	4	FG03700009				8 kant

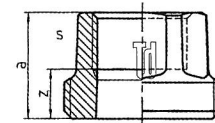

**371**

Union end

Einlegeteil

Pièce folle

Pezzo folle

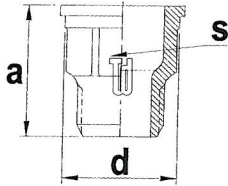

Dimension			Code	Index	Bag	Carton	Gr
Gew.374 » G«							
BLK	1/2 "	1	FS03710002	3,85		350	80
GLV	1/2 "	1	FG03710002	4,80		350	85
BLK	3/4 "	1	FS03710003	3,65		250	95
GLV	3/4 "	1	FG03710003	4,45		250	100
BLK	1 "	2	FS03710004	4,35		160	150
GLV	1 "	2	FG03710004	5,50		160	155
BLK	1 1/4 "	2	FS03710005	7,65		80	330
GLV	1 1/4 "	2	FG03710005	9,45		80	340
BLK	1 1/2 "	2	FS03710006	8,70		75	340
GLV	1 1/2 "	2	FG03710006	10,95		75	355
BLK	2 "	3	FS03710007	12,35		40	485
GLV	2 "	3	FG03710007	15,45		40	515

Dimension			Code	a	d	s	
Gew.374 » G«							
BLK	1/2 "	1	FS03710002	40	31.8	26	6 kant
GLV	1/2 "	1	FG03710002				6 kant
BLK	3/4 "	1	FS03710003	42	35.8	31	6 kant
GLV	3/4 "	1	FG03710003				6 kant
BLK	1 "	2	FS03710004	47	41.3	38	6 kant
GLV	1 "	2	FG03710004				6 kant
BLK	1 1/4 "	2	FS03710005	55	52.7	47	6 kant
GLV	1 1/4 "	2	FG03710005				6 kant
BLK	1 1/2 "	2	FS03710006	58	58.7	53	6 kant
GLV	1 1/2 "	2	FG03710006				6 kant
BLK	2 "	3	FS03710007	63	73.7	65	6 kant
GLV	2 "	3	FG03710007				6 kant

372

Union end

Einlegteil

Pièce folle

Pezzo folle



Dimension		Code	Index	Bag	Carton	Gr
Gew.374 » G«						
BLK 1/2 "-1 "	1	FS0372002A	2,45		400	60
GAL 1/2 "-1 "	1	FG0372002A	3,20		400	65
BLK 1/2 "-1 1/8 "	1	FS0372002B	2,50		400	60
GAL 1/2 "-1 1/8 "	1	FG0372002B	3,35		400	65
BLK 3/4 "-1 1/4 "	1	FS0372003C	2,55		350	70
GAL 3/4 "-1 1/4 "	1	FG0372003C	3,50		350	80
BLK 1 "-1 1/2 "	2	FS0372004D	2,60		300	90
GAL 1 "-1 1/2 "	2	FG0372004D	3,80		300	95
BLK 1 1/4 "-2 "	2	FS0372005E	4,05		150	165
GAL 1 1/4 "-2 "	2	FG0372005E	5,15		150	170
BLK 1 1/2 "-2 1/4 "	2	FS0372006F	5,50		110	170
GAL 1 1/2 "-2 1/4 "	2	FG0372006F	7,00		110	195
BLK 2 "-2 3/4 "	3	FS0372007G	8,85		70	290
GAL 2 "-2 3/4 "	3	FG0372007G	11,00		70	305
BLK 2 1/2 "-3 1/2 "	4	FS0372008H	19,30		35	545
GAL 2 1/2 "-3 1/2 "	4	FG0372008H	24,35		35	560
BLK 3 "-4 "	4	FS0372009J	35,05		25	655
GAL 3 "-4 "	4	FG0372009J	44,35		25	675

Dimension		Code	a	d	z	s
Gew.374 » G«						
BLK 1/2 "-1 "	1	FS0372002A	22	27.1	7	26
GAL 1/2 "-1 "	1	FG0372002A				
BLK 1/2 "-1 1/8 "	1	FS0372002B	21	31.8	9	26
GAL 1/2 "-1 1/8 "	1	FG0372002B				
BLK 3/4 "-1 1/4 "	1	FS0372003C	22	35.8	7	31
GAL 3/4 "-1 1/4 "	1	FG0372003C				
BLK 1 "-1 1/2 "	2	FS0372004D	25	41.3	8	38
GAL 1 "-1 1/2 "	2	FG0372004D				
BLK 1 1/4 "-2 "	2	FS0372005E	30	52.7	11	48
GAL 1 1/4 "-2 "	2	FG0372005E				
BLK 1 1/2 "-2 1/4 "	2	FS0372006F	32	58.7	13	54
GAL 1 1/2 "-2 1/4 "	2	FG0372006F				
BLK 2 "-2 3/4 "	3	FS0372007G	34	73.7	10	65
GAL 2 "-2 3/4 "	3	FG0372007G				
BLK 2 1/2 "-3 1/2 "	4	FS0372008H	37	92.9	10	83
GAL 2 1/2 "-3 1/2 "	4	FG0372008H				
BLK 3 "-4 "	4	FS0372009J	41	104.7	11	97
GAL 3 "-4 "	4	FG0372009J				

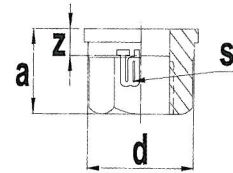



374

Union nut

Überwurfmutter

Ecrou

Dado

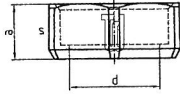

Dimension		Code	Index	Bag	Carton	Gr
Gew.374 » G«						
BLK	1/2 "-1 "	1	FS037402AS	1,75	350	70
GAL	1/2 "-1 "	1	FG037402AS	2,30	350	75
BLK	1/2 "-1 1/8 "	1	FS037402BS	2,25	350	70
GAL	1/2 "-1 1/8 "	1	FG037402BS	2,80	350	80
BLK	3/4 "-1 1/4 "	1	FS037403CS	2,25	220	125
GAL	3/4 "-1 1/4 "	1	FG037403CS	2,90	220	130
BLK	1 "-1 1/2 "	2	FS037404DS	2,60	180	110
GAL	1 "-1 1/2 "	2	FG037404DS	3,52	180	115
BLK	1 1/4 "-2 "	2	FS037405ES	4,05	110	235
GAL	1 1/4 "-2 "	2	FG037405ES	5,35	110	240
BLK	1 1/2 "-2 1/4 "	2	FS037406FS	5,15	80	210
GAL	1 1/2 "-2 1/4 "	2	FG037406FS	6,30	80	220
BLK	2 "-2 3/4 "	3	FS037407GS	7,25	60	265
GAL	2 "-2 3/4 "	3	FG037407GS	9,15	60	285
BLK	2 1/2 "-3 1/2 "	4	FS037408HS	17,95	30	460
GAL	2 1/2 "-3 1/2 "	4	FG037408HS	22,65	30	480
BLK	3 "-4 "	4	FS037409JS	23,10	20	935
GAL	3 "-4 "	4	FG037409JS	29,20	20	945

Dimension		Code	a	d	s		
Gew.374 » G«							
BLK	1/2 "-1 "	1	FS037402AS	18	27.5	41	6 kant
GAL	1/2 "-1 "	1	FG037402AS				6 kant
BLK	1/2 "-1 1/8 "	1	FS037402BS	19	32	42	6 kant
GAL	1/2 "-1 1/8 "	1	FG037402BS				6 kant
BLK	3/4 "-1 1/4 "	1	FS037403CS	20	36	50	6 kant
GAL	3/4 "-1 1/4 "	1	FG037403CS				6 kant
BLK	1 "-1 1/2 "	2	FS037404DS	22	41.5	55	6 kant
GAL	1 "-1 1/2 "	2	FG037404DS				6 kant
BLK	1 1/4 "-2 "	2	FS037405ES	24	53	68	8 kant
GAL	1 1/4 "-2 "	2	FG037405ES				8 kant
BLK	1 1/2 "-2 1/4 "	2	FS037406FS	25	59	75	8 kant
GAL	1 1/2 "-2 1/4 "	2	FG037406FS				8 kant
BLK	2 "-2 3/4 "	3	FS037407GS	27	74	90	8 kant
GAL	2 "-2 3/4 "	3	FG037407GS				8 kant
BLK	2 1/2 "-3 1/2 "	4	FS037408HS	30	92.5	110	8 kant
GAL	2 1/2 "-3 1/2 "	4	FG037408HS				8 kant
BLK	3 "-4 "	4	FS037409JS	31	105	130	8 kant
GAL	3 "-4 "	4	FG037409JS				8 kant

529a

ISO/EN (M4)

Extension socket

Verlängerung

Allonge

Prolungamento

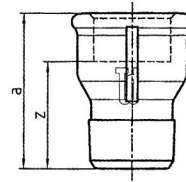

Dimension	Code	Index	Bag	Carton	Gr
BLK 1/2 "	FS529A0002	2,80	10	350	76
GLV 1/2 "	FG529A0002	3,55	10	350	79
BLK 3/4 "	FS529A0003	4,10	10	200	103
GLV 3/4 "	FG529A0003	5,30	10	200	106
BLK 1 "	FS529A0004	6,45	10	150	150
GLV 1 "	FG529A0004	8,20	10	150	172

Dimension	Code	a	z
BLK 1/2 "	FS529A0002	43	30
GLV 1/2 "	FG529A0002		
BLK 3/4 "	FS529A0003	48	33
GLV 3/4 "	FG529A0003		
BLK 1 "	FS529A0004	55	38
GLV 1 "	FG529A0004		

- Packaging
- Verpackung
- Emballage
- Imballaggio

- The size of boxes is 36 x 24 x 21 cm.
- Die Kartonabmessung ist 36 x 24 x 21 cm.
- La dimension des cartons est 36 x 24 x 21 cm.
- La dimensione di cartoni e 36 x 24 x 21 cm.



Td packaging system consists of 36 boxes measuring 36 x 24 x 21 cm, placed on a pallet measuring 80 x 120 cm.

- The index and piece weight values in this catalogue are for general purposes only. The piece weights given are nominal values. Differences in piece weights can occur due to technical reasons. Trakya Döküm reserves the right to make changes in values of this catalogue without providing any information beforehand.
- Die im Katalog angegebenen Index u. Gewichtswerte dienen zur allgemeinen Information. Die angegebenen Werte sind nominale Werte. Es können aus technischen u. Prozessgründen Gewichtsabweichungen auftreten. Trakya Döküm hat das Recht die Wertangaben in diesem Katalog unverbindlich zu ändern.
- Les valeurs (de poids et d'index) indiquées dans ce catalogue sont des valeurs nominales, à titre informatif. Des écarts dus à la technique peuvent surgir dans les valeurs (de poids). Trakya Dokum tient le droit d'effectuer des changements sur les prix indiqués dans ce catalogue sans avis préalable.
- I valori dell'indice e dei pesi relativi ai pezzi presenti in questo catalogo sono finalizzati a dare un'idea generale. I valori relativi ai pesi sono nominali. Differenze di peso possono verificarsi a causa di motivi tecnici. Trakya Döküm si riserva il diritto di effettuare modificazioni sui valori del presente catalogo senza anticipazioni.

Zertifikat

ZERTIFIKAT

Die Firma
Trakya Döküm San Ve Tic A.S.
in
Büyükkarıştiran

hat nachgewiesen, daß sie Gewindefittings nach EN 10242
entsprechend Design-Symbol A und gemäß
TÜV Rheinland Werkstoffblatt für
Fittings aus Temperguß, Ausgabe 7/98,
herstellen und liefern kann.

Köln, 28. Juli 1998

Dr.-Ing. Wolfgang Wichert

Dipl.-Ing. Dieter Imbusch

0193686A_TURAKYADOKUMSANVE TIC A.S. ZERTIFIKAT 000718

BUREAU VERITAS
Certification

Certification
Awarded to

TRAKYA DÖKÜM SAN. VE TİC. A.Ş.
BÜYÜKKARIŞTIRAN MEVKİİ, 39750
LÜLEBURGAZ, KIRKLARELİ, TURKEY

Bureau Veritas Certification certify that the Management System of the above organisation has been audited and found to be in accordance with the requirements of the management system standards detailed below

Standards

OHSAS 18001:2007

Scope of supply

MANUFACTURE OF GREY, DUCTILE AND BLACK HEART MALLEABLE IRON AS ROUGH AND MACHINED PARTS

Original Approval Date 30 MAY 2005

Subject to the continued satisfactory operation of the organisation's Management System, this certificate is valid until: 26 MAY 2011

To check this certificate validity please call (+90 216 518 40 50)

Further clarifications regarding the scope of this certificate and the applicability of the management system requirements may be obtained by consulting the organisation.

Certificate Number **30213** Date **20 JANUARY 2009**

MAHMUT GENÇ
Certification Manager



Bureau Veritas Güçten Hizmetleri Ltd. Şti.
Aydınevler Sanayi Çukuru, Centrum İş Merkezi No 3 Kat 1 48544, Kuşçubalı, İstanbul, TÜRKİYE

BUREAU VERITAS
Certification

Certification
Awarded to

TRAKYA DÖKÜM SANAYİ VE TİCARET A.Ş.
BÜYÜKKARIŞTIRAN MEVKİİ 39750
LÜLEBURGAZ, KIRKLARELİ, TURKEY

Bureau Veritas Certification certify that the Management System of the above organisation has been audited and found to be in accordance with the requirements of the management system standards detailed below

Standards

ISO 14001:2004

Scope of supply

MANUFACTURE OF GREY, DUCTILE AND BLACK HEART MALLEABLE IRON AS ROUGH AND MACHINED PARTS

Original Approval Date 03 SEPTEMBER 2004

Subject to the continued satisfactory operation of the organisation's Management System, this certificate is valid until: 03 SEPTEMBER 2010

To check this certificate validity please call + 90 216 518 40 50

Further clarifications regarding the scope of this certificate and the applicability of the management system requirements may be obtained by consulting the organisation.

Certificate Number **218368** Date **20 JANUARY 2009**

MAHMUT GENÇ
Certification Manager

UKAS
008

Bureau Veritas Güçten Hizmetleri Ltd. Şti.
Aydınevler Sanayi Çukuru İş Merkezi No 3 Kat 1 48544, Kuşçubalı, İstanbul, TÜRKİYE

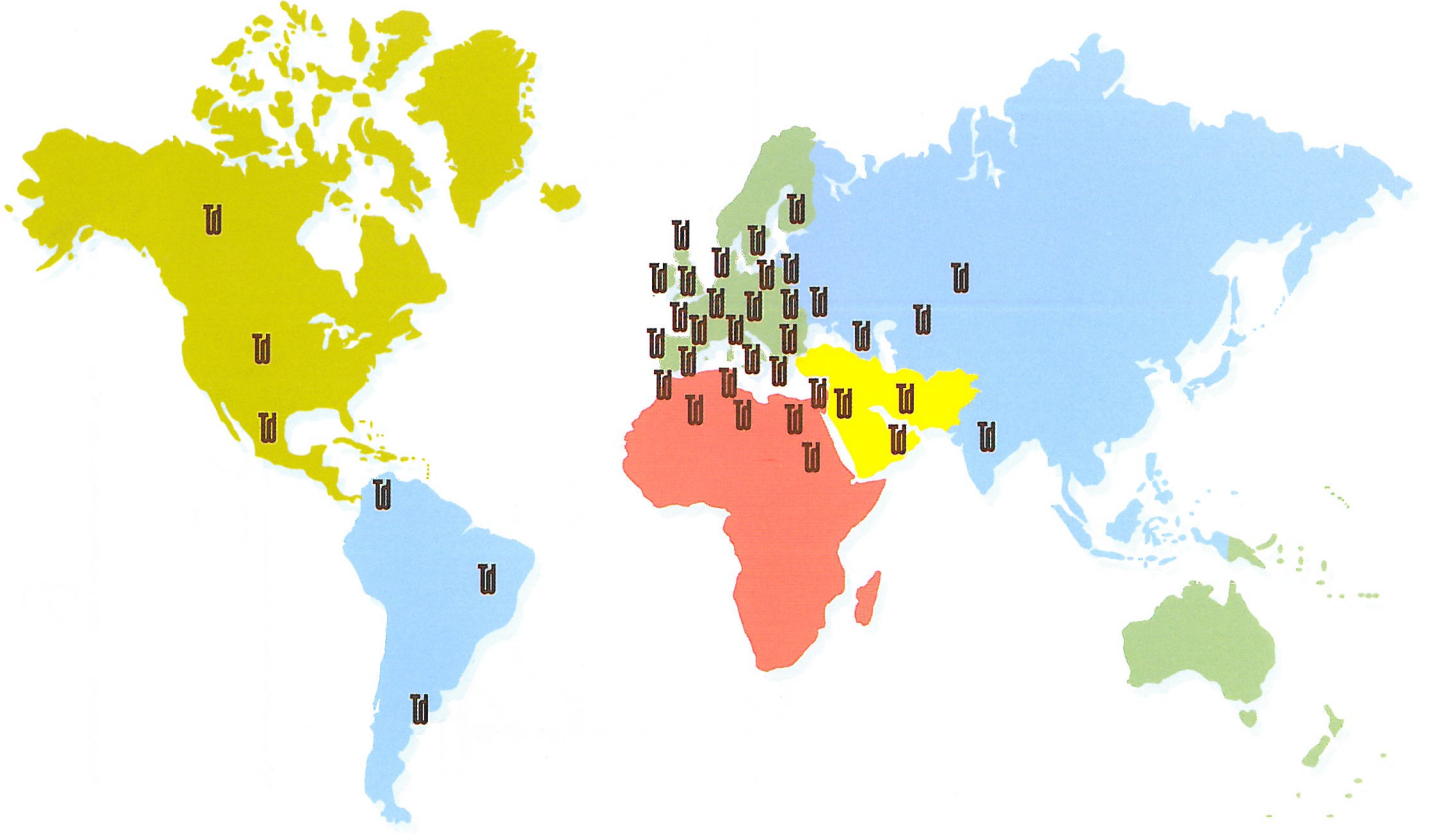

Exclusive Exporter:

ERKU

Foreign Trade & Marketing Inc.

Soyak Binası, Büyükdere Cad. No: 38 Kat: 2
34394 Mecidiyeköy - İSTANBUL / TURKEY
Tel : (90.212) 315 53 40 Fax: (90.212) 275 75 63
www.erku.com.tr e-mail: info@erku.com.tr

